

**NOTICE!!**

**These documents have been scanned!**

**Do not place un-scanned documents beneath this notice!**

**Do not remove this notice from this file!**

GPO Jacket No. 560-102  
Print Order 61540  
Rise Business Services, LLC  
Job=AZ15 6/6/2019



Box Number= AZ15121



Claim Begin-End: AMC358854-AMC358859

**1 Initial Receipt**



AZ15121-5 AMC358544-AMC359395

AMC 358854

Closed

9/1/05

" "

"

AMC 358855

" "

"

AMC 358858

**United States Department of the Interior**  
**Bureau of Land Management**  
 BUSINESS & SUPPORT SVCS DIV  
 222 N CENTRAL AVE  
 PHOENIX, AZ 85004 -2203  
 Phone: (602) 417-9200

Receipt

No: 792509

Transaction #: 823065  
 Date of Transaction: 12/03/2003

CUSTOMER: WALTER SONNENBERG  
 N 12315 WHEELER LN  
 ATHELSTANE, WI 54104

**ENTERED IN COMPUTER**  
 RE 12/5/2003

LINE #	QTY	DESCRIPTION	REMARKS	UNIT PRICE	TOTAL
1	6.00	LOCATABLE MINERALS / MINING CLAIMS-NEW, UNADJUDI, ONE OR MORE AUTH NO'S / NEW MINING CLAIM LOCATION FEE \$25(1993) <b>CASES:</b> AMC358854/\$25.00, AMC358855/\$25.00, AMC358856/\$25.00, AMC358857/\$25.00, AMC358858/\$25.00, AMC358859/\$25.00		- n/a -	150.00
2	6.00	LOCATABLE MINERALS / MINING CLAIMS-NEW, UNADJUDI, ONE OR MORE AUTH NO'S / NEW MINING CLAIM SVC CHG \$10 (1930) <b>CASES:</b> AMC358854/\$10.00, AMC358855/\$10.00, AMC358856/\$10.00, AMC358857/\$10.00, AMC358858/\$10.00, AMC358859/\$10.00		- n/a -	60.00
3	6.00	LOCATABLE MINERALS / MINING CLAIMS-NEW, UNADJUDI, ONE OR MORE AUTH NO'S / NEW MINING CLM MAINT FEE \$100(1993) <b>CASES:</b> AMC358854/\$100.00, AMC358855/\$100.00, AMC358856/\$100.00, AMC358857/\$100.00, AMC358858/\$100.00, AMC358859/\$100.00		- n/a -	600.00
<b>TOTAL:</b>					<b>\$810.00</b>

**PAYMENT INFORMATION**

NOTE: Items will appear on credit card statement as "Bureau of Land Management".

1	AMOUNT: \$810.00	POSTMARKED: N/A
	TYPE: CREDIT CARD	RECEIVED: 12/03/2003
	NAME: SONNENBERG, WALTER N 12315 WHEELER LN ATHELSTANE WI 54104	
	CARD NO: XXXXXXXXXXXXX6041	AUTH CODE: 003237
	NAME ON CARD: SONNENBERG/WALTER J	
	EXPIRES: 11/30/2004	
	SIGNATURE:	

**REMARKS**

This receipt was generated by the automated BLM Collections and Billing System and is a paper representation of a portion of the official electronic record contained therein.

**NOTICE!!**

**These documents have been scanned!**

**Do not place un-scanned documents beneath this notice!**

**Do not remove this notice from this file!**

GPO Jacket No. 560-102  
Print Order 61540  
Rise Business Services, LLC  
Job=AZ15 6/6/2019



Box Number= AZ15121



Claim Begin-End: AMC358854-AMC358859

**2 Correspondence**



AZ15121-5

AMC358544-AMC359395



# United States Department of the Interior

BUREAU OF LAND MANAGEMENT  
Arizona State Office  
One North Central Avenue, Suite 800  
Phoenix, AZ 85004-4427  
www.az.blm.gov



In Reply Refer To:  
3800 (AZ-933) DS  
AMC358854

March 24, 2006

CERTIFIED MAIL - RETURN RECEIPT REQUESTED

## DECISION

SONNENBERG WALTER : This decision affects those claims shown  
N 12315 WHEELER LN : in the block below:  
ATHELSTANE, WI 54104 :

---

AMC358854, 358855, 358858  
MISSOURI #1, #2, #5

---

### MINING CLAIMS DECLARED FORFEITED

The mining claims listed above have been declared forfeited for failure to file the required maintenance fee payment or small miner's maintenance fee waiver (waiver).

Claimants are required to pay an annual non-refundable maintenance fee of \$125, or submit a waiver, on or before September 1 of each year. These requirements were established by 30 U.S.C. 28-f-k, as amended, and 43 Code of Federal Regulations (CFR) 3834 and 3835.

Our records do not show receipt of a maintenance fee payment, or waiver received on or before September 1, 2005, for the 2006 assessment year, for the claims listed above. Therefore, the claims are forfeited.

You are required to reclaim all areas disturbed by your activities on lands encompassed by your mining claim(s) and/or site(s). After you complete the reclamation, you must notify the authorized officer of the appropriate surface managing agency so that the authorized officer may conduct a final site inspection and determine whether you may be released from liability. If you fail to reclaim the land to the satisfaction of the authorized officer, the surface management agency may cite you for noncompliance under its surface management regulations.

**SENDER: COMPLETE THIS SECTION**

- Complete items 1, 2, and 3. Also complete item 4 if Restricted Delivery is desired.
- Print your name and address on the reverse so that we can return the card to you.
- Attach this card to the back of the mailpiece, or on the front if space permits.

1. Article Addressed to:

SONNENBERG WALTER  
 N 12315 WHEELER LN  
 ATHELSTANE, WI 54104  
 933(DS)AMC358854

**COMPLETE THIS SECTION ON DELIVERY**

A. Signature

X

*Elise Sommerberg*

 Agent Addressee

B. Received by (Printed Name)

*Elise Sommerberg*

C. Date of Delivery

*3/30/06*

D. Is delivery address different from item 1?  YesIf YES, enter delivery address below:  No

3. Service Type

 Certified Mail Express Mail Registered Return Receipt for Merchandise Insured Mail C.O.D.

4. Restricted Delivery? (Extra Fee)

 Yes

2. Article Number

7001 1940 0005 3530 7395

(Transfer from service label)

UNITED STATES POSTAL SERVICE

GREEN BAY WI 543

30 MAR 2005 JENT 2 T

First-Class Mail  
Postage & Fees Paid  
USPS  
Permit No. G-10

- Sender: Please print your name, address, and ZIP+4 in this box •

RECEIVED  
BUREAU OF  
LAND MANAGEMENT  
30 APR -3 P 2:23  
U.S. DEPARTMENT OF THE INTERIOR  
BUREAU OF LAND MANAGEMENT  
ARIZONA STATE OFFICE  
ONE NORTH CENTRAL AVE. SUITE 800  
PHOENIX, ARIZONA 85004-4427

AZ  
933

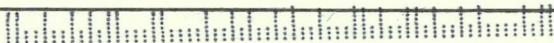

For land administered by the Bureau of Land Management (BLM), if you fail to reclaim the land to the satisfaction of the authorized officer as required in 43 CFR Subpart 3809, BLM will issue an order of noncompliance under 43 CFR 3809.601(a). If you fail to comply with the noncompliance order, BLM may take further action under 43 CFR 3809.604. Failure to conduct reclamation is a prohibited act that may subject you to criminal penalties.

See 43 CFR 3809.605(h) and 43 CFR 3809.700.

This decision may be appealed to the Interior Board of Land Appeals, Office of the Secretary, in accordance with the regulations contained in 43 CFR, Part 4 and the enclosed Form 1842-1. If an appeal is taken, your notice of appeal must be filed in this office (at the above address) within 30 days from receipt of this decision. The appellant has the burden of showing that the decision appealed from is in error.

If you wish to file a petition pursuant to regulation 43 CFR 4.21 (58 FR 4939, January 19, 1993) for a stay of the effectiveness of this decision during the time that your appeal is being reviewed by the Board, the petition for a stay must accompany your notice of appeal. A petition for a stay is required to show sufficient justification based on the standards listed below. Copies of the notice of appeal and petition for a stay **must** also be submitted to each party named in this decision and to the Interior Board of Land Appeals and to the appropriate Office of the Solicitor (see 43 CFR 4.413) at the same time the original documents are filed with this office. If you request a stay, you have the burden of proof to demonstrate that a stay should be granted.

#### Standards for Obtaining a Stay

Except as otherwise provided by law or other pertinent regulation, a petition for a stay of a decision pending appeal shall show sufficient justification based on the following standards:

- (1) The relative harm to the parties if the stay is granted or denied,
- (2) The likelihood of the appellant's success on the merits,
- (3) The likelihood of immediate and irreparable harm if the stay is not granted, and
- (4) Whether the public interest favors granting the stay.

Please include your AMC serial number(s) on all correspondence. If additional information is required, please call Dominic Sarracino at 602-417-9346.



Alvin L. Burch  
Group Administrator  
Renewable Resources and Minerals Group

Enclosure  
Appeal Form 1842-1





# United States Department of the Interior



BUREAU OF LAND MANAGEMENT  
Arizona State Office  
One North Central Avenue, Suite 800  
Phoenix, Arizona 85004-4427  
[www.blm.gov/az/](http://www.blm.gov/az/)

In Reply Refer To:  
3800 (AZ-933) RE  
AMC358854

February 12, 2008

CERTIFIED MAIL - RETURN RECEIPT REQUESTED No. 7005 3110 0000 2181 6919

## DECISION

SONNENBERG WALTER J  
N 12315 WHEELER LN  
ATHELSTANE, WISCONSIN 54104

:  
:  
:

This decision affects those claims shown  
in the block below:

---

AMC358859  
MISSOURI #6

---

## MINING CLAIMS DECLARED FORFEITED

The mining claims listed above have been declared forfeited for failure to file the required maintenance fee payment or small miner's maintenance fee waiver (waiver).

Claimants are required to pay an annual non-refundable maintenance fee of \$125, or submit a waiver, on or before September 1 of each year. These requirements were established by 30 (United States Code) 28-f-k, as amended, and 43 Code of Federal Regulations (CFR) 3834 and 3835.

Our records do not show receipt of a maintenance fee payment, or waiver received on or before September 1, 2007, for the 2008 assessment year, for the claims listed above. Therefore, the claims are forfeited.

This decision does not relieve you of the liability for reclamation of all areas disturbed by your activities on lands covered by the subject mining claim(s) and/or site(s). After you complete the reclamation, you must notify the authorized officer of the appropriate surface managing agency so that the authorized officer may conduct a final site inspection and determine whether you may be released from liability.

If you fail to reclaim the land to the satisfaction of the authorized officer, the surface management agency may cite you for noncompliance under its surface management regulations.

For land administered by the Bureau of Land Management (BLM), if you fail to reclaim the land to the satisfaction of the authorized officer as required in 43 CFR Subpart 3809, BLM will issue an order of noncompliance under 43 CFR 3809.601(a). If you fail to comply with the noncompliance order, BLM may take further action under 43 CFR 3809.604. Failure to conduct reclamation is a prohibited act that may subject you to criminal penalties. See 43 CFR 3809.605(h) and 43 CFR 3809.700.

This decision may be appealed to the Interior Board of Land Appeals, Office of the Secretary, in accordance with the regulations contained in 43 CFR, Part 4, and the enclosed Form 1842-1. If an appeal is taken, your notice of appeal must be filed in this office (at the above address) within 30 days from receipt of this decision. The appellant has the burden of showing that the decision appealed from is in error.

If you wish to file a petition pursuant to regulation 43 CFR 4.21 (58 FR 4939, January 19, 1993) for a stay of the effectiveness of this decision during the time that your appeal is being reviewed by the Board, the petition for a stay must accompany your notice of appeal. A petition for a stay is required to show sufficient justification based on the standards listed below. Copies of the notice of appeal and petition for a stay must also be submitted to each party named in this decision and to the Interior Board of Land Appeals and to the appropriate Office of the Solicitor (see 43 CFR 4.413) at the same time the original documents are filed with this office. If you request a stay, you have the burden of proof to demonstrate that a stay should be granted.

#### Standards for Obtaining a Stay

Except as otherwise provided by law or other pertinent regulation, a petition for a stay of a decision pending appeal shall show sufficient justification based on the following standards:

- (1) The relative harm to the parties if the stay is granted or denied,
- (2) The likelihood of the appellant's success on the merits,
- (3) The likelihood of immediate and irreparable harm if the stay is not granted, and
- (4) Whether the public interest favors granting the stay.

Please include your AMC serial number(s) on all correspondence. If additional information is required, please call Rod Ebert at 602-417-9397.



Alvin L. Burch  
Group Administrator  
Renewable and Mineral Resources Group

Enclosure  
Appeal Form 1842-1

**SENDER: COMPLETE THIS SECTION**

- Complete items 1, 2, and 3. Also complete item 4 if Restricted Delivery is desired.
- Print your name and address on the reverse so that we can return the card to you.
- Attach this card to the back of the mailpiece, or on the front if space permits.

1. Article Addressed to:

**FEB 12 2008**

**SONNENBERG WALTER J  
N 12315 WHEELER LN  
ATHELSTANE, WI 54104**

**AMC358854 (RE)**

2. Article Number

(Transfer from service)

**7005 3110 0000 2181 6919****COMPLETE THIS SECTION ON DELIVERY**

A. Signature

**X***Walter Sonnenberg*  
*Walter Sonnenberg* Agent Addressee

B. Received by (Printed Name)

C. Date of Delivery

**2-22-08**

D. Is delivery address different from item 1?

 Yes

If YES, enter delivery address below:

 No

3. Service Type

 Certified Mail Express Mail Registered Insured Mail C.O.D.

4. Restricted Delivery? (Extra Fee)

 Yes

UNITED STATES POSTAL SERVICE

GREEN BAY WI 543

22 FEB 2008 PM 2 T

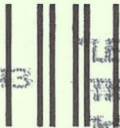

LET US DARE TO DREAM  
THINK, SPEAK AND WRITE.  
John Adams  
First-Class Mail  
Postage & Fees Paid  
USPS  
Permit No. G-10

• Sender: Please print your name, address, and ZIP+4 in this box •

AZ  
933

U.S. DEPARTMENT OF THE INTERIOR  
BUREAU OF LAND MANAGEMENT  
ARIZONA STATE OFFICE  
ONE NORTH CENTRAL AVE. SUITE 800  
PHOENIX, ARIZONA 85004-4427

www.bureauoflandmanagement.com  
ARIZONA STATE OFFICE  
PHOENIX, ARIZONA  
2008 FEB 25 P 1:27  
RECEIVED  
BUREAU OF  
LAND MANAGEMENT



**NOTICE!!**

**These documents have been scanned!**

**Do not place un-scanned documents beneath this notice!**

**Do not remove this notice from this file!**

GPO Jacket No. 560-102  
Print Order 61540  
Rise Business Services, LLC  
Job=AZ15 6/6/2019



Box Number= AZ15121



Claim Begin-End: AMC358854-AMC358859

**3 Transfers**



AZ15121-5

AMC358544-AMC359395

**NO  
DOCUMENTS  
FOUND**

NO DOCUMENTS FOUND  
NO DOCUMENTS FOUND

**NOTICE!!**

**These documents have been scanned!**

**Do not place un-scanned documents beneath this notice!**

**Do not remove this notice from this file!**

GPO Jacket No. 560-102  
Print Order 61540  
Rise Business Services, LLC  
Job=AZ15 6/6/2019



Box Number= AZ15121



Claim Begin-End: AMC358854-AMC358859

**4 Annual Filings**



AZ15121-5

AMC358544-AMC359395

UNITED STATES  
DEPARTMENT OF THE INTERIOR  
BUREAU OF LAND MANAGEMENT

358854

**CREDIT CARD PAYMENT**  
**For Mining Claim Maintenance Fee**

THIS IS A CHANGE OF ADDRESS

TELEPHONE SUBMISSION - ACCURACY OF THE BELOW INFORMATION IS THE RESPONSIBILITY OF THE CLAIMANT/OWNER

NAME WALTER SONNENBERG  
ADDRESS N 12315 WHEELER LANE  
CITY ATHELSTONE STATE WI ZIP 54104  
PHONE # 520-241-1514

SEND RECEIPT TO  Above address  
 Other (Include Name and Mailing Address):

RECEIVED  
BLMAZ STATE OFFICE  
2020 AUG - 1 A 11:44  
PHOENIX, ARIZONA

AMC NUMBER 358856 CLAIM/SITE NAME MISSOURI MINE #3  
358857 MISSOURI MINE #4

Lowry  
Sent Letter Admins  
Abandon / Requirement Not Met

2 # of Claim/Site  
x 165.00 Each  
\$ 330.00 Total Charged PER (INITIALS)  
RECEIPT # 4518247

DATE STAMP

RECEIVED  
STATE OFFICE  
2019 JUL 29 P 2:10  
PHOENIX, ARIZONA

# 4776426

\*\*\*\*\* FOR OFFICIAL USE ONLY \*\*\*\*\*  
DATE \_\_\_\_\_ INITIALS \_\_\_\_\_ VERIFIED \_\_\_\_\_  
INTERED  
AUG 10 2020  
BY: WV



**United States Department of the Interior**  
**Bureau of Land Management**  
 DIV OF LANDS, MINRLS & ENERGY  
 ONE N CENTRAL AVE  
 PHOENIX, AZ 85004 -4427  
 Phone: 602-417-9200

Receipt

No: 4518247

Transaction #: 4638856  
 Date of Transaction: 07/29/2019

RECEIVED  
 BLM AZ STATE OFFICE  
 2020 AUG - 7 A 11: 44  
 PHOENIX, ARIZONA

CUSTOMER:

WALTER SONNENBERG  
 N12315 WHEELER LN  
 SILVER CLIFF, WI 54104-9503 US

LINE #	QTY	DESCRIPTION	REMARKS	UNIT PRICE	TOTAL
1	1.00	LOCATABLE MINERALS / MINING CLAIMS- NOT NEW-UNADJUD, ONE AUTH NO. ONLY / MINING CLAIM MONEY RECEIVED CASES: AMC358856/\$330.00	2020 MAINT/2	- n/a -	330.00
<b>TOTAL:</b>					<b>\$330.00</b>

PAYMENT INFORMATION

NOTE: Items will appear on credit card statement as "Bureau of Land Mgmt CO".

1	AMOUNT:	330.00	POSTMARKED:	N/A
	TYPE:	CREDIT CARD	RECEIVED:	07/29/2019
	NAME:	SONNENBERG, WALTER N12315 WHEELER LN SILVER CLIFF WI 54104-9503 US		
	CARD NO:	XXXXXXXXXXXX9145	AUTH CODE:	029009
	NAME ON CARD:	WALTER SONNENBERG		
	SIGNATURE:			

REMARKS

This receipt was generated by the automated BLM Collections and Billing System and is a paper representation of a portion of the official electronic record contained therein.

**United States Department of the Interior**  
**Bureau of Land Management**  
 DIV OF LANDS, MINRLS & ENERGY  
 ONE N CENTRAL AVE  
 PHOENIX, AZ 85004 -4427  
 Phone: 602-417-9200

Receipt

No:

4776426

<b>Transaction #:</b> 4903357	
<b>Date of Transaction:</b> 08/07/2020	
<b>CUSTOMER:</b>	
WALTER SONNENBERG N12315 WHEELER LN SILVER CLIFF, WI 54104-9503 US	

LINE #	QTY	DESCRIPTION	REMARKS	UNIT PRICE	TOTAL
1	1.00	LOCATABLE MINERALS / MINING CLAIMS-NOT NEW-UNADJUD, ONE AUTH NO. ONLY / MINING CLAIM MONEY RECEIVED CASES: AMC358856/\$330.00	MAINT 2021	- n/a -	330.00
<b>TOTAL:</b>					<b>\$330.00</b>

PAYMENT INFORMATION			
1	AMOUNT:	330.00	POSTMARKED: N/A
	TYPE:	CHECK	RECEIVED: 08/07/2020
	CHECK NO:	9136	
	NAME:	SONNENBERG, WALTER N12315 WHEELER LN SILVER CLIFF WI 54104-9503 US	

<b>REMARKS</b>

This receipt was generated by the automated BLM Collections and Billing System and is a paper representation of a portion of the official electronic record contained therein.



**Sgt Walter J Sonnenberg**  
 N12315 Wheeler Ln.  
 Silver Cliff, WI 54104-9503

PLACE STICKER AT TOP OF ENVELOPE TO THE RIGHT  
 OF THE RETURN ADDRESS, FOLD AT DOTTED LINE

**CERTIFIED MAIL®**

GREEN BAY  
 WI 543  
 04 AUG 20  
 PM 3 L



7017 1070 0000 3846 4787

Bureau of LAND MANAGEMENT  
 Div of LAND, MINERALS & ENERGY  
 ONE N CENTRAL AVE  
 SUITE 800  
 PHOENIX AZ

85004-4427

8500434427 C041



UNITED STATES POSTAGE  
  
 PITNEY BOWERS  
 02 1P \$ 006.4  
 0004756017 AUG 04 2020  
 MAILED FROM ZIP CODE 54104

ILLEGAL STATE OFFICE

1 2020 AUG -7 A 11: 44

PHOENIX

UNITED STATES  
DEPARTMENT OF THE INTERIOR  
BUREAU OF LAND MANAGEMENT

AMC 358854

**CREDIT CARD PAYMENT**  
**For Mining Claim Maintenance Fee**

THIS IS A CHANGE OF ADDRESS

TELEPHONE SUBMISSION - ACCURACY OF THE BELOW INFORMATION IS THE RESPONSIBILITY OF THE CLAIMANT/OWNER

NAME WALTER SONNENBERG

ADDRESS N 12315 WHEELER LANE

CITY ATHELSTONE STATE WI ZIP 54104

PHONE # 520 - 241-1514

SEND RECEIPT TO  Above address

Other (Include Name and Mailing Address):

\_\_\_\_\_  
\_\_\_\_\_  
\_\_\_\_\_

AMC NUMBER  
358856  
358857

CLAIM/SITE NAME  
MISSOURI MINE #3  
MISSOURI MINE #4

2 # of Claim/Site  
x 165.00 Each  
\$ 330.00 Total Charged PER (INITIALS)

RECEIPT # 4518247

DATE STAMP

RECEIVED  
STATE OFFICE  
2019 JUL 29 P 2:10  
PHOENIX, ARIZONA

\*\*\*\* FOR OFFICIAL USE ONLY \*\*\*\*

DATE \_\_\_\_\_ INITIALS \_\_\_\_\_ VERIFIED \_\_\_\_\_

ENTERED  
JUL 30 2019  
BY: [Signature]

5/20/2019  
Sent letter advising  
Abandon/Requirement Not Met

**United States Department of the Interior**  
**Bureau of Land Management**  
 DIV OF LANDS, MINRLS & ENERGY  
 ONE N CENTRAL AVE  
 PHOENIX, AZ 85004 -4427  
 Phone: 602-417-9200

Receipt	
No:	4518247

**Transaction #:** 4638856  
**Date of Transaction:** 07/29/2019

CUSTOMER:	
WALTER SONNENBERG N12315 WHEELER LN SILVER CLIFF, WI 54104-9503 US	

LINE #	QTY	DESCRIPTION	REMARKS	UNIT PRICE	TOTAL
1	1.00	LOCATABLE MINERALS / MINING CLAIMS- NOT NEW-UNADJUD, ONE AUTH NO. ONLY / MINING CLAIM MONEY RECEIVED <b>CASES: AMC358856/\$330.00</b>	2020 MAINT/2	- n/a -	330.00
<b>TOTAL:</b>					<b>\$330.00</b>

PAYMENT INFORMATION			
NOTE: Items will appear on credit card statement as "Bureau of Land Mgmt CO".			
1	AMOUNT:	330.00	POSTMARKED: N/A
	TYPE:	CREDIT CARD	RECEIVED: 07/29/2019
	NAME:	SONNENBERG, WALTER N12315 WHEELER LN SILVER CLIFF WI 54104-9503 US	
	CARD NO:	XXXXXXXXXXXX9145	AUTH CODE: 029009
	NAME ON CARD:	WALTER SONNENBERG	
	SIGNATURE:		

REMARKS

This receipt was generated by the automated BLM Collections and Billing System and is a paper representation of a portion of the official electronic record contained therein.

Run Date: 08/07/18

Run Time: 04:41 PM

**DEPARTMENT OF THE INTERIOR  
BUREAU OF LAND MANAGEMENT  
MINING CLAIMS**

**MC Maintenance Fees Paid Through the BLM Pay Portal**

**CBS Receipt: 4226395**

Printed For Lead File # AMC358854

Agency Tracking ID: 1533243167

Assessment Year: 2019

Number of BLM Serial Nr: 2

Paid On: 08/02/2018

Total Amount Paid: \$310.00

Claim Name	BLM Serial No	Lead File No	Amount Paid
MISSOURI #3	AMC358856	AMC358854	\$155.00
MISSOURI #4	AMC358857	AMC358854	\$155.00

**United States Department of the Interior**  
**Bureau of Land Management**  
 BUSINESS & SUPPORT SVCS DIV  
 ONE N CENTRAL AVE SUITE 800  
 PHOENIX, AZ 85004 -4427  
 Phone: 602-417-9200

Receipt

No: 4226395

<b>Transaction #:</b> 4341645	
<b>Date of Transaction:</b> 08/02/2018	
CUSTOMER:	
WALTER J SONNENBERG N 12315 WHEELER LN SILVER CLIFF, WI 54104 US	

LINE #	QTY	DESCRIPTION	REMARKS	UNIT PRICE	TOTAL
1	1.00	LOCATABLE MINERALS / MINING CLAIMS- NOT NEW-UNADJUD, ONE AUTH NO. ONLY / MINING CLAIM MONEY RECEIVED CASES: AMC358856/\$310.00		- n/a -	310.00
<b>TOTAL:</b>					<b>\$310.00</b>

PAYMENT INFORMATION				
NOTE: Items will appear on credit card statement as "BLM O Mining Claim".				
1	AMOUNT:	310.00	POSTMARKED:	N/A
	TYPE:	CREDIT CARD	RECEIVED:	08/02/2018
	NAME:	WALTER J SONNENBERG N 12315 WHEELER LN SILVER CLIFF WI 54104 US		
	CARD NO:	XXXXXXXXXXXX0617	AUTH CODE:	164383
	NAME ON CARD:	WALTER J SONNENBERG		
	SIGNATURE:			

REMARKS

This receipt was generated by the automated BLM Collections and Billing System and is a paper representation of a portion of the official electronic record contained therein.

UNITED STATES  
DEPARTMENT OF THE INTERIOR  
BUREAU OF LAND MANAGEMENT

358854

**CREDIT CARD PAYMENT**  
**For Mining Claim Maintenance Fee**

THIS IS A CHANGE OF ADDRESS

TELEPHONE SUBMISSION - ACCURACY OF THE BELOW INFORMATION IS THE RESPONSIBILITY OF THE CLAIMANT/OWNER

NAME WALTER SOMMENBERG  
ADDRESS N 12315 WHEELER LANE  
CITY SILVER CLIFF STATE WI ZIP 54104  
PHONE # 520 - 241-1514

SEND RECEIPT TO  Above address  
 Other (Include Name and Mailing Address):

\_\_\_\_\_  
\_\_\_\_\_  
\_\_\_\_\_

AMC NUMBER

358856  
358857

CLAIM/SITE NAME

MISSOURI #3  
MISSOURI #4

2 Lodes  
# of Claim/Site  
x 155.00 Each  
\$ 310.00 Total Charged ES (INITIALS)  
RECEIPT # 3909141

DATE STAMP

ENTERED  
JUL 28 2017  
BY: RAM

RECEIVED  
BLMAZ STATE OFFICE  
2011 JUL 27 P 1:15  
PHOTOGRAPHY

\*\*\*\* FOR OFFICIAL USE ONLY \*\*\*\*

DATE \_\_\_\_\_ INITIALS \_\_\_\_\_ VERIFIED \_\_\_\_\_



**United States Department of the Interior**  
**Bureau of Land Management**  
 DIV OF LANDS, MINRLS & ENERGY  
 ONE N CENTRAL AVE  
 PHOENIX, AZ 85004 -4427  
 Phone: 602-417-9200

Receipt

No: 3909141

<b>Transaction #:</b> 4018530	
<b>Date of Transaction:</b> 07/27/2017	
CUSTOMER:	
WALTER SONNENBERG N12315 WHEELER LN SILVER CLIFF, WI 54104-9503 US	

LINE #	QTY	DESCRIPTION	REMARKS	UNIT PRICE	TOTAL
1	1.00	LOCATABLE MINERALS / MINING CLAIMS- NOT NEW-UNADJUD, ONE AUTH NO. ONLY / MINING CLAIM MONEY RECEIVED <b>CASES: AMC358856/\$310.00</b>	2018 MAINT (2)	- n/a -	310.00
<b>TOTAL:</b>					<b>\$310.00</b>

PAYMENT INFORMATION			
NOTE: Items will appear on credit card statement as "Bureau of Land Mgmt CO".			
1	AMOUNT:	310.00	POSTMARKED: N/A
	TYPE:	CREDIT CARD	RECEIVED: 07/27/2017
	NAME:	SONNENBERG, WALTER N12315 WHEELER LN SILVER CLIFF WI 54104-9503 US	
	CARD NO:	XXXXXXXXXXXX3997	AUTH CODE: 006815
	NAME ON CARD:	WALTER SONNENBERG	
	EXPIRES:	07/2020	
	SIGNATURE:		

REMARKS

This receipt was generated by the automated BLM Collections and Billing System and is a paper representation of a portion of the official electronic record contained therein.

358854

UNITED STATES  
DEPARTMENT OF THE INTERIOR  
BUREAU OF LAND MANAGEMENT

**CREDIT CARD PAYMENT**  
**For Mining Claim Maintenance Fee**

THIS IS A CHANGE OF ADDRESS

TELEPHONE SUBMISSION - ACCURACY OF THE BELOW INFORMATION IS THE RESPONSIBILITY OF THE CLAIMANT/OWNER

NAME Walter SONNENBERG  
ADDRESS N. 12315 Wheeler Ln  
CITY Silver Cliff STATE WI ZIP 54104  
PHONE # 520 - 241-1514

SEND RECEIPT TO  Above address  
 Other (Include Name and Mailing Address):  
\_\_\_\_\_  
\_\_\_\_\_  
\_\_\_\_\_

AMC NUMBER 358856 CLAIM/SITE NAME Missouri 3  
358857 Missouri 4

*Code*  
# of Claim/Site 2  
x 155.00 Each  
\$ 310 Total Charged ES (INITIALS)

RECEIPT # 3607033

DATE STAMP

ENTERED  
JUL 18 2016  
BY: RAM

RECEIVED  
BUREAU OF LAND MANAGEMENT  
2016 JUL 15 A 11:00  
TUCSON, ARIZONA

\*\*\*\*\* FOR OFFICIAL USE ONLY \*\*\*\*\*

DATE \_\_\_\_\_ INITIALS \_\_\_\_\_ VERIFIED \_\_\_\_\_

**United States Department of the Interior  
Bureau of Land Management  
DIV OF LANDS, MINRLS & ENERGY  
ONE N CENTRAL AVE  
PHOENIX, AZ 85004 -4427  
Phone: 602-417-9200**

Receipt

No: 3607033

<b>Transaction #:</b> 3710460	
<b>Date of Transaction:</b> 07/15/2016	
<b>CUSTOMER:</b>	
WALTER SONNENBERG N12315 WHEELER LN SILVER CLIFF, WI 54104-9503 US	

LINE #	QTY	DESCRIPTION	REMARKS	UNIT PRICE	TOTAL
1	1.00	LOCATABLE MINERALS / MINING CLAIMS- NOT NEW-UNADJUD, ONE AUTH NO. ONLY / MINING CLAIM MONEY RECEIVED CASES: AMC358856/\$310.00	2017 MAINT (2)	- n/a -	310.00
<b>TOTAL:</b>					<b>\$310.00</b>

PAYMENT INFORMATION			
NOTE: Items will appear on credit card statement as "Bureau of Land Mgmt CO".			
1	AMOUNT:	310.00	POSTMARKED: N/A
	TYPE:	CREDIT CARD	RECEIVED: 07/15/2016
	NAME:	SONNENBERG, WALTER N12315 WHEELER LN SILVER CLIFF WI 54104-9503 US	
	CARD NO:	XXXXXXXXXXXX0617	AUTH CODE: 135496
	NAME ON CARD:	WALTER J SONNENBERG	
	EXPIRES:	08/2017	
	SIGNATURE:		

<b>REMARKS</b>

This receipt was generated by the automated BLM Collections and Billing System and is a paper representation of a portion of the official electronic record contained therein.

358854

UNITED STATES  
DEPARTMENT OF THE INTERIOR  
BUREAU OF LAND MANAGEMENT

**CREDIT CARD PAYMENT**  
**For Mining Claim Maintenance Fee**

THIS IS A CHANGE OF ADDRESS

TELEPHONE SUBMISSION - ACCURACY OF THE BELOW INFORMATION IS THE RESPONSIBILITY OF THE CLAIMANT/OWNER

NAME Walter Sonnenberg  
ADDRESS N 12315 Wheeler Ln.  
CITY Silver Cliff STATE WI ZIP 54104  
PHONE # 520 - 241-1514

SEND RECEIPT TO  Above address  
 Other (Include Name and Mailing Address):

\_\_\_\_\_  
\_\_\_\_\_  
\_\_\_\_\_

AMC NUMBER

358856 - 20  
358857 - 20

CLAIM/SITE NAME

\_\_\_\_\_  
\_\_\_\_\_  
\_\_\_\_\_

2 # of Claim/Site  
x 155.00 Each  
\$ 310 Total Charged MLC (INITIALS)

RECEIPT # 333 9776

DATE STAMP

RECEIVED  
BLM AZ STATE OFFICE  
2015 JUL 10 P 12:25  
PHOENIX, ARIZONA

ENTERED  
JUL 13 2015  
BY: R Am

\*\*\*\*\* FOR OFFICIAL USE ONLY \*\*\*\*\*

DATE \_\_\_\_\_ INITIALS \_\_\_\_\_ VERIFIED \_\_\_\_\_

**United States Department of the Interior  
Bureau of Land Management  
LANDS/RECREATION & PLANNING  
ONE N CENTRAL AVE  
PHOENIX, AZ 85004 -2203  
Phone: 602-417-9200**

Receipt

No: 3339776

<b>Transaction #:</b> 3437409	
<b>Date of Transaction:</b> 07/10/2015	
<b>CUSTOMER:</b>	
WALTER SONNENBERG N12315 WHEELER LN ATHELSTANE, WI 54104-9503 US	

LINE #	QTY	DESCRIPTION	REMARKS	UNIT PRICE	TOTAL
1	1.00	LOCATABLE MINERALS / MINING CLAIMS- NOT NEW-UNADJUD, ONE AUTH NO. ONLY / MINING CLAIM MONEY RECEIVED <b>CASES: AMC358856/\$310.00</b>	MAINT 2016/2	- n/a -	310.00
<b>TOTAL:</b>					<b>\$310.00</b>

PAYMENT INFORMATION			
NOTE: Items will appear on credit card statement as "Bureau of Land Mgmt CO".			
1	AMOUNT:	310.00	POSTMARKED: N/A
	TYPE:	CREDIT CARD	RECEIVED: 07/10/2015
	NAME:	SONNENBERG, WALTER N12315 WHEELER LN ATHELSTANE WI 54104-9503 US	
	CARD NO:	XXXXXXXXXXXX0617	AUTH CODE: 052482
	NAME ON CARD:	WALTER SONNENBERG	
	EXPIRES:	08/2017	
	SIGNATURE:		

REMARKS

This receipt was generated by the automated BLM Collections and Billing System and is a paper representation of a portion of the official electronic record contained therein.

**ENTERED**  
JUL 13 2015  
BY: RAM

UNITED STATES  
DEPARTMENT OF THE INTERIOR  
BUREAU OF LAND MANAGEMENT

AMC 358854

**CREDIT CARD PAYMENT**  
**For Mining Claim Maintenance Fee**

THIS IS A CHANGE OF ADDRESS

TELEPHONE SUBMISSION - ACCURACY OF THE BELOW INFORMATION IS THE RESPONSIBILITY OF THE CLAIMANT/OWNER

NAME Walter Sonnenberg  
ADDRESS N 12315 Wheeler Ln.  
CITY Silver Cliff STATE WI ZIP 54104  
PHONE # 530 - 241-1514

SEND RECEIPT TO  Above address

Other (Include Name and Mailing Address):  
\_\_\_\_\_  
\_\_\_\_\_  
\_\_\_\_\_

AMC NUMBER  
358856  
358857

CLAIM/SITE NAME  
MISSOURI #3  
MISSOURI #4

2 # of Claim/Site  
x 155.00 Each  
\$ 310 Total Charged WMS (INITIALS)

RECEIPT # 3077069

DATE STAMP

RECEIVED  
M AZ STATE OFFICE  
2014 JUL 15 P 12: 27  
PHOENIX, ARIZONA

ENTERED  
JUL 17 2014  
BY: RAM

\*\*\*\* FOR OFFICIAL USE ONLY \*\*\*\*

DATE \_\_\_\_\_ INITIALS \_\_\_\_\_ VERIFIED \_\_\_\_\_

**United States Department of the Interior**  
**Bureau of Land Management**  
 LANDS/RECREATION & PLANNING  
 ONE N CENTRAL AVE  
 PHOENIX, AZ 85004 -2203  
 Phone: 602-417-9200

Receipt

No: 3077609

<b>Transaction #:</b> 3168833	
<b>Date of Transaction:</b> 07/15/2014	
CUSTOMER:	
WALTER SONNENBERG N12315 WHEELER LN SILVER CLIFF, WI 54104-9503 US	

LINE #	QTY	DESCRIPTION	REMARKS	UNIT PRICE	TOTAL
1	1.00	LOCATABLE MINERALS / MINING CLAIMS- NOT NEW-UNADJUD, ONE AUTH NO. ONLY / MINING CLAIM MONEY RECEIVED <b>CASES: AMC358856/\$310.00</b>	MAINT 2015/2	- n/a -	310.00
<b>TOTAL:</b>					<b>\$310.00</b>

PAYMENT INFORMATION			
NOTE: Items will appear on credit card statement as "Bureau of Land Mgmt CO".			
1	AMOUNT:	310.00	POSTMARKED: N/A
	TYPE:	CREDIT CARD	RECEIVED: 07/15/2014
	NAME:	SONNENBERG, WALTER N12315 WHEELER LN SILVER CLIFF WI 54104-9503 US	
	CARD NO:	XXXXXXXXXXXX7518	AUTH CODE: 005228
	NAME ON CARD:	WALTER SONNENBERG	
	EXPIRES:	04/2016	
	SIGNATURE:		

REMARKS

This receipt was generated by the automated BLM Collections and Billing System and is a paper representation of a portion of the official electronic record contained therein.

UNITED STATES  
DEPARTMENT OF THE INTERIOR  
BUREAU OF LAND MANAGEMENT

Amc 358854

**CREDIT CARD PAYMENT**  
For Mining Claim Maintenance Fee

THIS IS A CHANGE OF ADDRESS

TELEPHONE SUBMISSION - ACCURACY OF THE BELOW INFORMATION IS THE RESPONSIBILITY OF THE CLAIMANT/OWNER

NAME Walter Sonnenberg  
ADDRESS 12315 Wheeler Ln  
CITY Silver Cliff STATE WI ZIP 54104-9503  
PHONE # 520 - 241.1514 cell

SEND RECEIPT TO  Above address  
 Other (include Name and Mailing Address):  
\_\_\_\_\_  
\_\_\_\_\_  
\_\_\_\_\_

AMC NUMBER

358856  
358857  
\_\_\_\_\_

CLAIM/SITE NAME

Missouri 3  
Missouri 4  
\_\_\_\_\_

2 # of Claim/Site  
x 140.00 Each  
\$ 280 - Total Charged WCH (INITIALS)

RECEIPT # 2832579

DATE STAMP

RECEIVED  
BLM AZ STATE OFFICE  
2013 JUL 15 P 1:18  
PHOENIX, ARIZONA

ENTERED INTO COMPUTER

7/19/13 AEE

\*\*\*\*\* FOR OFFICIAL USE ONLY \*\*\*\*\*

DATE \_\_\_\_\_ INITIALS \_\_\_\_\_ VERIFIED \_\_\_\_\_



**United States Department of the Interior**  
**Bureau of Land Management**  
 LANDS/RECREATION & PLANNING  
 ONE N CENTRAL AVE  
 PHOENIX, AZ 85004 -2203  
 Phone: 602-417-9200

Receipt

No: 2832519

<b>Transaction #:</b> 2917974	
<b>Date of Transaction:</b> 07/15/2013	
<b>CUSTOMER:</b>	
WALTER SONNENBERG N12315 WHEELER LN SILVER CLIFF, WI 54104-9503 US	

LINE #	QTY	DESCRIPTION	REMARKS	UNIT PRICE	TOTAL
1	1.00	LOCATABLE MINERALS / MINING CLAIMS- NOT NEW-UNADJUD, ONE AUTH NO. ONLY / MINING CLAIM MONEY RECEIVED <b>CASES: AMC358856/\$280.00</b>	MAINT 2014/2	- n/a -	280.00
<b>TOTAL:</b>					<b>\$280.00</b>

PAYMENT INFORMATION					
NOTE: Items will appear on credit card statement as "Bureau of Land Mgmt CO".					
1	AMOUNT:	280.00	POSTMARKED:	N/A	
	TYPE:	CREDIT CARD	RECEIVED:	07/15/2013	
	NAME:	SONNENBERG, WALTER N12315 WHEELER LN SILVER CLIFF WI 54104-9503 US			
	CARD NO:	XXXXXXXXXXXX7518	AUTH CODE:	002461	
	NAME ON CARD:	WALTER J SONNENBERG			
	EXPIRES:	04/2016			
	SIGNATURE:				

REMARKS

This receipt was generated by the automated BLM Collections and Billing System and is a paper representation of a portion of the official electronic record contained therein.

Amc 358854

UNITED STATES  
DEPARTMENT OF THE INTERIOR  
BUREAU OF LAND MANAGEMENT

CREDIT CARD PAYMENT  
FOR MINING CLAIM MAINTENANCE FEE

NAME Walter Sonnenberg

ADDRESS N 12315 Wheeler Lane ✓

CITY Silver Cliffe STATE WI ZIP 54104

PHONE # (520) 241-1514

SEND RECEIPT TO ABOVE ADDRESS   
SEND RECEIPT TO: \_\_\_\_\_

AMC NUMBER

358856

CLAIM/SITE NAME

Missouri 3 Lode 20.606A

358857

Missouri 4 Lode Claim 20.606A

ENTERED INTO COMPUTER

JUL 19 2012 PB

RECEIVED  
DATE STAMP  
BLM AZ STATE OFFICE  
2012 JUL -2 A 10:34  
PHOENIX, ARIZONA

TELEPHONE SUBMISSION - ACCURACY OF THE ABOVE INFORMATION  
IS THE RESPONSIBILITY OF THE CLAIMANT/OWNER

FOR OFFICIAL USE ONLY

DATE \_\_\_\_\_ INITIALS \_\_\_\_\_ VERIFIED \_\_\_\_\_

COUNT 2 \$ 280 INITIALS trh

**United States Department of the Interior**  
**Bureau of Land Management**  
 LANDS/RECREATION & PLANNING  
 ONE N CENTRAL AVE  
 PHOENIX, AZ 85004 -2203  
 Phone: 602-417-9200

Receipt

No: 2600653

<b>Transaction #:</b> 2680644	<b>ENTERED INTO COMPUTER</b>
<b>Date of Transaction:</b> 07/02/2012	
<b>CUSTOMER:</b> JUL 19 2012 <i>JB</i>	
WALTER SONNENBERG N12315 WHEELER LN SILVER CLIFF, WI 54104-9503 US	

LINE #	QTY	DESCRIPTION	REMARKS	UNIT PRICE	TOTAL
1	1.00	LOCATABLE MINERALS / MINING CLAIMS- NOT NEW-UNADJUD, ONE AUTH NO. ONLY / MINING CLAIM MONEY RECEIVED CASES: AMC358856/\$280.00	MAINT 2013/2	- n/a -	280.00
<b>TOTAL:</b>					<b>\$280.00</b>

PAYMENT INFORMATION			
NOTE: Items will appear on credit card statement as "Bureau of Land Mgmt CO".			
1	AMOUNT:	280.00	POSTMARKED: N/A
	TYPE:	CREDIT CARD	RECEIVED: 07/02/2012
	NAME:	SONNENBERG, WALTER N12315 WHEELER LN SILVER CLIFF WI 54104-9503 US	
	CARD NO:	XXXXXXXXXXXX1982	AUTH CODE: 046371
	NAME ON CARD:	WALTER J SONNENBERG	
	EXPIRES:	03/2015	
	SIGNATURE:		

REMARKS

This receipt was generated by the automated BLM Collections and Billing System and is a paper representation of a portion of the official electronic record contained therein.

AMC 358854

UNITED STATES  
DEPARTMENT OF THE INTERIOR  
BUREAU OF LAND MANAGEMENT

**CREDIT CARD PAYMENT**  
**For Mining Claim Maintenance Fee**

THIS IS A CHANGE OF ADDRESS

TELEPHONE SUBMISSION - ACCURACY OF THE BELOW INFORMATION IS THE RESPONSIBILITY OF THE CLAIMANT/OWNER

NAME Walter Sonnenberg  
ADDRESS N 12315 Whaler Ln  
CITY Silver cliff STATE WI ZIP 54104  
PHONE # 520 - 241-1514

SEND RECEIPT TO  Above address  
 Other (Include Name and Mailing Address):

\_\_\_\_\_  
\_\_\_\_\_  
\_\_\_\_\_

AMC NUMBER  
358856  
358857

CLAIM/SITE NAME  
Missouri Mine #3  
Missouri Mine #4

2 # of Claim/Site  
x 140.00 Each  
\$ 280 Total Charged W (INITIALS)

RECEIPT # 2391745

DATE STAMP  
**ENTERED INTO COMPUTER**  
JUL 29 2011  
PHOENIX, ARIZONA  
RECEIVED  
BLMAZ STATE OFFICE  
2011 JUL 28 A 10:16

\*\*\*\*\* FOR OFFICIAL USE ONLY \*\*\*\*\*  
DATE \_\_\_\_\_ INITIALS \_\_\_\_\_ VERIFIED \_\_\_\_\_

**United States Department of the Interior**  
**Bureau of Land Management**  
 LANDS/RECREATION & PLANNING  
 ONE N CENTRAL AVE  
 PHOENIX, AZ 85004 -2203  
 Phone: 602-417-9200

Receipt

No: 2391745

<b>Transaction #:</b> 2466811		<b>ENTERED INTO COMPUTER</b>
<b>Date of Transaction:</b> 07/28/2011		
<b>CUSTOMER:</b> JUL 29 2011 <i>PS</i>		
WALTER SONNENBERG N12315 WHEELER LN SILVER CLIFF, WI 54104-9503 US		

LINE #	QTY	DESCRIPTION	REMARKS	UNIT PRICE	TOTAL
1	1.00	LOCATABLE MINERALS / MINING CLAIMS-NOT NEW-UNADJUD, ONE AUTH NO. ONLY / MINING CLAIM MONEY RECEIVED <b>CASES: AMC358856/\$280.00</b>	MAINT FEE PYMNT (2) 2012	- n/a -	280.00
<b>TOTAL:</b>					<b>\$280.00</b>

PAYMENT INFORMATION				
NOTE: Items will appear on credit card statement as "Bureau of Land Mgmt CO".				
1	AMOUNT:	280.00	POSTMARKED:	N/A
	TYPE:	CREDIT CARD	RECEIVED:	07/28/2011
	NAME:	SONNENBERG, WALTER N12315 WHEELER LN SILVER CLIFF WI 54104-9503 US		
	CARD NO:	XXXXXXXXXXXX1673	AUTH CODE:	09652C
	NAME ON CARD:	WALTER J SONNENBERG		
	EXPIRES:	04/2013		
	SIGNATURE:			

REMARKS

This receipt was generated by the automated BLM Collections and Billing System and is a paper representation of a portion of the official electronic record contained therein.

UNITED STATES  
DEPARTMENT OF THE INTERIOR  
BUREAU OF LAND MANAGEMENT

AMC 358854

**CREDIT CARD PAYMENT**  
**For Mining Claim Maintenance Fee**

THIS IS A CHANGE OF ADDRESS

TELEPHONE SUBMISSION - ACCURACY OF THE BELOW INFORMATION IS THE RESPONSIBILITY OF THE CLAIMANT/OWNER

NAME Walter SONNENBERG  
ADDRESS N-12315 Wheeler LN ✓  
CITY Silver Cliff STATE WI ZIP 54104  
PHONE # 715 - 856-5798

SEND RECEIPT TO  Above address  
 Other (Include Name and Mailing Address):  
\_\_\_\_\_  
\_\_\_\_\_  
\_\_\_\_\_

AMC NUMBER  
358856  
358857  
\_\_\_\_\_

CLAIM/SITE NAME  
Missouri #3  
Missouri #4  
\_\_\_\_\_

ENTERED INTO COMPUTER

cy  
AUG 18 2010

2 # of Claim/Site  
x 140.00 Each  
\$ 280 Total Charged EC (INITIALS)  
RECEIPT # 2187768

DATE STAMP

RECEIVED  
BLM AZ STATE OFFICE  
2010 AUG 10 A 11:43  
PHOENIX, ARIZONA

\*\*\*\*\* FOR OFFICIAL USE ONLY \*\*\*\*\*

DATE \_\_\_\_\_ INITIALS \_\_\_\_\_ VERIFIED \_\_\_\_\_

**United States Department of the Interior  
Bureau of Land Management  
LANDS/RECREATION & PLANNING  
ONE N CENTRAL AVE  
PHOENIX, AZ 85004 -2203  
Phone:**

Receipt

No: 2187768

<b>Transaction #:</b> 2257457		ENTERED INTO COMPUTER
<b>Date of Transaction:</b> 08/10/2010		
<b>CUSTOMER:</b>	WALTER SONNENBERG N12315 WHEELER LN SILVER CLIFF, WI 54104-9503 US	AUG 18 2010

LINE #	QTY	DESCRIPTION	REMARKS	UNIT PRICE	TOTAL
1	1.00	LOCATABLE MINERALS / MINING CLAIMS- NOT NEW-UNADJUD, ONE AUTH NO. ONLY / MINING CLAIM MONEY RECEIVED <b>CASES: AMC358856/\$280.00</b>	2011 MAINT (2)	- n/a -	280.00 <span style="color: blue;">✓</span>
<b>TOTAL:</b>					<b>\$280.00</b>

PAYMENT INFORMATION			
NOTE: Items will appear on credit card statement as "Bureau of Land Mgmt CO".			
1	AMOUNT:	280.00	POSTMARKED: N/A
	TYPE:	CREDIT CARD	RECEIVED: 08/10/2010
	NAME:	SONNENBERG, WALTER N12315 WHEELER LN SILVER CLIFF WI 54104-9503 US	
	CARD NO:	XXXXXXXXXXXX0003	AUTH CODE: 642611
	NAME ON CARD:	WALTER J SONNENBERG	
	EXPIRES:	04/2011	
	SIGNATURE:		

REMARKS

This receipt was generated by the automated BLM Collections and Billing System and is a paper representation of a portion of the official electronic record contained therein.

AMC 358854

UNITED STATES  
DEPARTMENT OF THE INTERIOR  
BUREAU OF LAND MANAGEMENT

**CREDIT CARD PAYMENT**  
**For Mining Claim Maintenance Fee**

THIS IS A CHANGE OF ADDRESS

TELEPHONE SUBMISSION - ACCURACY OF THE BELOW INFORMATION IS THE RESPONSIBILITY OF THE CLAIMANT/OWNER

NAME Walter J. Sonnenberg  
ADDRESS N 12315 Wheeler LN  
CITY Silver Cliff STATE WI ZIP 54104  
PHONE # 520 - 241-1514

SEND RECEIPT TO  Above address  
 Other (Include Name and Mailing Address):  
\_\_\_\_\_  
\_\_\_\_\_  
\_\_\_\_\_

AMC NUMBER

358856

358857

CLAIM/SITE NAME

Missouri #3

Missouri #4

2 # of Claim/Site

~~x140. +25.00~~ Each

\$280.00 Total Charged AH (INITIALS)

#1968174

RECEIVED  
BLM AZ STATE OFFICE  
2009 JUL 29 P 1:28  
PHOENIX, ARIZONA  
DATE STAMP

\*\*\*\*\* FOR OFFICIAL USE ONLY \*\*\*\*\*

DATE \_\_\_\_\_ INITIALS \_\_\_\_\_ VERIFIED \_\_\_\_\_

ENTERED INTO COMPUTER  
8/4/09 BJG



United States Department of the Interior  
 Bureau of Land Management  
 BUSINESS & SUPPORT SVCS DIV  
 ONE N CENTRAL AVE SUITE 800  
 PHOENIX, AZ 85004 -4427  
 Phone: (602) 417-9200

Receipt

No:

1968174

<b>Transaction #:</b> 2032012	
<b>Date of Transaction:</b> 07/31/2009	
<b>CUSTOMER:</b>	WALTER SONNENBERG N12315 WHEELER LN SILVER CLIFF, WI 54104-9503 US

LINE #	QTY	DESCRIPTION	REMARKS	UNIT PRICE	TOTAL
1	1.00	LOCATABLE MINERALS / MINING CLAIMS-NOT NEW-UNADJUD, ONE AUTH NO. ONLY / MINING CLAIM MONEY RECEIVED CASES: AMC358856/\$280.00	MAINT 2010/2	- n/a -	280.00
<b>TOTAL:</b>					<b>\$280.00</b>

PAYMENT INFORMATION				
NOTE: Items will appear on credit card statement as "Bureau of Land Mgmt CO".				
1	AMOUNT:	280.00	POSTMARKED:	N/A
	TYPE:	CREDIT CARD	RECEIVED:	07/31/2009
	NAME:	SONNENBERG, WALTER J N12315 WHEELER LN SILVER CLIFF WI 54104-9503 US		
	CARD NO:	XXXXXXXXXXXX0003	AUTH CODE:	935317
	NAME ON CARD:	WALTER J SONNENBERT		
	EXPIRES:	04/2011		
	SIGNATURE:			

REMARKS

This receipt was generated by the automated BLM Collections and Billing System and is a paper representation of a portion of the official electronic record contained therein.

358854

UNITED STATES  
DEPARTMENT OF THE INTERIOR  
BUREAU OF LAND MANAGEMENT

CREDIT CARD PAYMENT  
FOR MINING CLAIM MAINTENANCE FEE

NAME Walter Sonnenberg

ADDRESS N 12315 Wheeler LN

CITY SILVER CLIFF STATE WI ZIP 54104

PHONE # (715) 856-5798

SEND RECEIPT TO ABOVE ADDRESS   
SEND RECEIPT TO: \_\_\_\_\_  
\_\_\_\_\_  
\_\_\_\_\_

AMC NUMBER  
358856  
358857

CLAIM/SITE NAME  
MISSOURI #3  
#4

ENTERED INTO COMPUTER

AUG 05 2008 *pb*

DATE STAMP

TELEPHONE SUBMISSION - ACCURACY OF THE ABOVE INFORMATION  
IS THE RESPONSIBILITY OF THE CLAIMANT/OWNER

FOR OFFICIAL USE ONLY

DATE \_\_\_\_\_ INITIALS \_\_\_\_\_ VERIFIED \_\_\_\_\_

COUNT 2 \$ 250 INITIALS EAC

PHOENIX, ARIZONA  
2008 AUG -4 P 3: 59  
RECEIVED B.L.M. AZ STATE OFFICE

**United States Department of the Interior**  
**Bureau of Land Management**  
 BUSINESS & SUPPORT SVCS DIV  
 ONE N CENTRAL AVE SUITE 800  
 PHOENIX, AZ 85004 -4427  
 Phone: (602) 417-9200

Receipt

No: 1753769

<b>Transaction #:</b> 1811075		<b>ENTERED INTO COMPUTER</b> AUG 05 2008 <i>PG</i>
<b>Date of Transaction:</b> 08/04/2008		
<b>CUSTOMER:</b>	WALTER SONNENBERG N 12315 WHEELER LN SILVER CLIFF, WI 54104	

LINE #	QTY	DESCRIPTION	REMARKS	UNIT PRICE	TOTAL
1	1.00	LOCATABLE MINERALS / MINING CLAIMS- NOT NEW-UNADJUD, ONE AUTH NO. ONLY / MINING CLAIM MONEY RECEIVED (455) CASES: AMC358856/\$250.00	2009 MAINT (2)	- n/a -	250.00
<b>TOTAL:</b>					<b>\$250.00</b>

PAYMENT INFORMATION			
NOTE: Items will appear on credit card statement as "Bureau of Land Mgmt CO".			
1	AMOUNT:	\$250.00	POSTMARKED: N/A
	TYPE:	CREDIT CARD	RECEIVED: 08/04/2008
	NAME:	SONNENBERG, WALTER N 12315 WHEELER LN SILVER CLIFF WI 54104	
	CARD NO:	XXXXXXXXXXXX1637	AUTH CODE: 02589B
	NAME ON CARD:	WALTER SONNENBERG	
	EXPIRES:	02/28/2011	
	SIGNATURE:		

REMARKS

This receipt was generated by the automated BLM Collections and Billing System and is a paper representation of a portion of the official electronic record contained therein.

AMC 358854

# United States Department of the Interior

BUREAU OF LAND MANAGEMENT  
ARIZONA STATE OFFICE  
ONE NORTH CENTRAL  
SUITE # 800  
PHOENIX, AZ 85004

## MINING CLAIM MAINTENANCE FEE 2008

NAME: WALTER SONNENBERG

DATE STAMP

ADDRESS: N 12315 WHEELER LANE

CITY : SILVER CLIFF STATE : WI ZIP: 54104

PHONE # (715 ) 856-5798

RECEIVED  
B.L.M. AZ STATE OFFICE  
2001 AUG 20 A 9:28  
PHOENIX, ARIZONA

SEND RECEIPT TO ABOVE ADDRESS   
SEND RECEIPT TO :

AMC NUMBER	CLAIM/SITE NAME
358856	MISSOURI # 3
358857	MISSOURI # 4

TELEPHONE SUBMISSION - ACCURACY OF THE ABOVE INFORMATION IS THE RESPONSIBILITY OF THE CLAIMANT / OWNER

No. of Claims	2	X	\$125 =	250
Check No:	credit Card			
Receipt No :	1547524			

United States Department of the Interior  
 Bureau of Land Management  
 BUSINESS & SUPPORT SVCS DIV  
 ONE N CENTRAL AVE SUITE 800  
 PHOENIX, AZ 85004 -4427  
 Phone: (602) 417-9200

Receipt

No: 1547526

<b>Transaction #:</b> 1598926	
<b>Date of Transaction:</b> 08/20/2007	
<b>CUSTOMER:</b>	WALTER SONNENBERG N 12315 WHEELER LN SILVER CLIFF, WI 54104

LINE #	QTY	DESCRIPTION	REMARKS	UNIT PRICE	TOTAL
1	1.00	LOCATABLE MINERALS / MINING CLAIMS-NOT NEW-UNADJUD, ONE AUTH NO. ONLY / MINING CLAIM MONEY RECEIVED (455) <b>CASES: AMC358856/\$250.00</b>	MAINT 2008 (2)	- n/a -	250.00
<b>TOTAL:</b>					<b>\$250.00</b>

PAYMENT INFORMATION					
NOTE: Items will appear on credit card statement as "Bureau of Land Management".					
1	AMOUNT:	\$250.00	POSTMARKED:	N/A	
	TYPE:	CREDIT CARD	RECEIVED:	08/20/2007	
	NAME:	SONNENBERG, WALTER N 12315 WHEELER LN SILVER CLIFF WI 54104			
	CARD NO:	XXXXXXXXXXXX1673	AUTH CODE:	02141C	
	NAME ON CARD:	WALTER SONNENBERG			
	EXPIRES:	08/31/2010			
	SIGNATURE:				

REMARKS

This receipt was generated by the automated BLM Collections and Billing System and is a paper representation of a portion of the official electronic record contained therein.

AMC 358854

**Authorized Date** 10/05/2006

**Instructions to Accounts** OVERPAYMENT. AMC358854. RECEIPT #1347655. REFUND  
AUTHORIZED. MH

**Login ID** 1440

**Entry Date** 10/05/2006

**Total Amount** \$30.00

ENTERED IN COMPUTER

RE 3/15/07

United States Department of the Interior  
 Bureau of Land Management  
 BUSINESS & SUPPORT SVCS DIV  
 ONE N CENTRAL AVE  
 PHOENIX, AZ 85004 -2203  
 Phone: (602) 417-9200

Receipt

No: 1347655

<b>Transaction #:</b> 1392939	
<b>Date of Transaction:</b> 08/30/2006	
<b>CUSTOMER:</b>	WALTER SONNENBERG N 12315 WHEELER LN ATHELSTANE, WI 54104
<b>ENTERED INTO COMPUTER</b> SEP 01 2006 <i>PB m/fee</i>	

LINE #	QTY	DESCRIPTION	REMARKS	UNIT PRICE	TOTAL
1	1.00	LOCATABLE MINERALS / MINING CLAIMS-NOT NEW-UNADJUD, ONE AUTH NO. ONLY / MINING CLAIM MONEY RECEIVED (455) CASES: AMC358856/\$435.00	MAINT 2007 ✓ (3), POL 2006 (3)	- n/a -	435.00
<b>TOTAL:</b>					<b>\$435.00</b>

PAYMENT INFORMATION			
1	AMOUNT:	\$435.00	POSTMARKED: N/A
	TYPE:	CHECK	RECEIVED: 08/29/2006
	CHECK NO:	7859	
	NAME:	SONNENBERG, WALTER J N 12315 WHEELER LN ATHELSTANE WI 54104	

REMARKS

This receipt was generated by the automated BLM Collections and Billing System and is a paper representation of a portion of the official electronic record contained therein.

AMC 358854

A3850-1(NOV.2001)

Return Document to:

WALTER Sonnenberg  
N 12315 Wheeler Ln  
Athelstane WI 54104  
Telephone: 715-856-5798

No. of Claims: _____	x <u>60</u>	_____
Receipt No.: _____	Check No.:	_____
Init: _____	FOR BLM USE ONLY	

**AFFIDAVIT OF PERFORMANCE OF ANNUAL WORK.** Also fill in Items 1 through 9 and the reverse side of this document.

**NOTICE OF INTENTION TO HOLD.** I intend to hold the claims(s)/site(s) listed on the reverse side of this document for the calendar year 20\_\_\_\_. Also fill in Items 1 through 4 and Item 9.

Notices of Intention to Hold are for mill sites and tunnel sites or for mining claims when assessment work has not been done, regardless of whether the annual assessment has been suspended, deferred, or not yet accrued. The filing of a Notice of Intention to Hold shall not relieve the owner of complying with federal and state laws pertaining to the performance of annual assessment work. Notices of Intention to Hold for mill sites or tunnel sites need not be county recorded. For mining claims the form filed with the Bureau of Land Management (BLM) must be identical to the one that was or will be filed with the county.

Evidence of Annual Assessment Work or a Notice of Intention to Hold must be filed each calendar year following the calendar year in which the claim/site was located. **All claims listed on a single affidavit must be contiguous.**

1. State of Arizona, County of Cochise ss:
2. I, (Name) WALTER Sonnenberg
3. Reside at (Address) N 12315 Wheeler Ln  
City Athelstane, County MARINETTE, State WI Zip 54104

being duly sworn, deposes and says that he/she is a citizen of the United States, more than eighteen years of age, that all of the facts set forth in this affidavit/notice, subject to the provisions and penalties of 18 U.S.C. 1001 pertaining to the filing of false, fictitious, or fraudulent statements with the United States, are true and correct according to the best of my knowledge, information and belief.

4. Owner's name and address (If not shown in Items 1-3 above). **Check here if this is a change of address.**

5. That I am personally acquainted with the mining claim(s). The work and improvements were made by and at the expense of the owner(s) of said claim(s). Said contiguous group of claims, listed on the reverse side of this document, are situated in the \_\_\_\_\_ Mining District, Cochise County, Arizona.

6. That between the dates starting at 12 o'clock noon on September 1, 2005 and ending at 12 o'clock noon on September 1, 2006 at least \$ 350<sup>00</sup> Dollars worth of work and improvements were done and performed upon said claim(s) or upon one or more of a contiguous group of claims for the benefit of all, or wholly or partly outside of a contiguous group of claims for the benefit of all, not including the location work.

7. That the following persons were employed to perform the work and improvements described herein: WALTER Sonnenberg

RECEIVED  
BLM  
AZ STATE OFFICE  
2006 AUG 21  
PHENIX, ARIZONA

ENTERED IN COMPUTER  
RE 10/1/06



8. That the work and improvements performed were: Worked on Road Had to replace stake missing Again

9. Dated: 8-25-06 Signature: Walter Sonnenberg

SUBSCRIBED AND SWORN TO before me, a Notary Public, this 25th day of August, 2006  
 by Walter Sonnenberg  
 Notary Public Carol L. Lafaive  
 MY COMMISSION EXPIRES 12-14-11 **CAROL L. LAFAIVE**  
**Notary Public, Dickinson Co., MI**  
**My Comm. Expires December 14, 2011**

If the claims/sites have consecutive BLM numbers and are in the same Township, Range and Section(s), they may be listed as follows:

Sample 1 - 10	A MC 19640 - 49	Dkt/Pg 1025/1-10 Recording #9106173-82	4N 20W 36
Claim/Site Name	Serial Number	Dkt/Pg or Record # of Orig Location Notice	TWN SHP RNG SEC(S)
<u>Missouri # 3</u>	<u>358856</u>	<u>031039401</u>	<u>18-323E 12</u>
<u>Missouri # 4</u>	<u>358857</u>	<u>031039402</u>	<u>11</u>
<u>Missouri # 6</u>	<u>358859</u>	<u>031039404</u>	<u>11</u>
_____	_____	_____	_____
_____	_____	_____	_____
_____	_____	_____	_____
_____	_____	_____	_____
_____	_____	_____	_____
_____	_____	_____	_____
_____	_____	_____	_____
_____	_____	_____	_____

BLM requires a \$5 nonrefundable service charge for each mining claim, mill site or tunnel site payable on or before December 30<sup>th</sup> (not the 31<sup>st</sup>). Mail to:

**Bureau of Land Management**  
**222 North Central Avenue**  
**Phoenix, Arizona 85004-2203**  
**602-417-9200**  
**www.az.blm.gov**

This form is for the purpose of complying with the laws of the United States Department of the Interior, Bureau of Land Management and the State of Arizona pertaining to assessment work and/or notice of intention to hold. 30 U.S.C. 28, 43 CFR 3833.2, ARS 27-208. Subject to Paperwork Reduction Act and Privacy Act statements available at the BLM AZ State Office. This form is not copyrighted. It may be reproduced without permission.

BLM Date Stamp

**MAINTENANCE FEE PAYMENT**

Mining Claim Maintenance Fee Payment of \$100 per claim or site is due on or before September 1, 2006, in lieu of assessment work for the upcoming assessment year beginning September 1 of the year noted above.

BUREAU OF LAND MANAGEMENT  
ARIZONA STATE OFFICE  
222 NORTH CENTRAL AVENUE  
PHOENIX, AZ 85004  
602-417-9200  
www.az.blm.gov

FOR BLM USE ONLY	
NO. OF CLAIMS: _____	X \$100 = \$ _____
RECEIPT NO: _____	CHECK NO: _____
INIT: _____	

BLM SERIAL NUMBERS	NAME OF CLAIMS/SITES	COUNTY BOOK/DOCKET & PAGE OR FEE NUMBER
1. AMC <u>358856</u>	<u>Missouri # 3</u>	<u>031039401</u>
2. AMC <u>358857</u>	<u>" # 4</u>	<u>031039402</u>
3. AMC <u>358859</u>	<u>" # 6</u>	<u>031039404</u>
4. AMC _____	_____	_____
5. AMC _____	_____	_____
6. AMC _____	_____	_____
7. AMC _____	_____	_____
8. AMC _____	_____	_____
9. AMC _____	_____	_____
10. AMC _____	_____	_____

**ENTERED INTO COMPUTER**  
SEP 01 2006 *FB*

List additional claims on the reverse side of this form.

CHECK HERE IF THIS IS A CHANGE OF ADDRESS

CLAIMANT'S NAME: WALTER SONNEBERG

ADDRESS: 112315 WHEELER LN

CITY: ATHLSTANE STATE: WI ZIP: 54104

PHONE: 715 856-5798

Signature: Walter Sonneberg

To record with the County, one claimant or an agent must sign.

PHOENIX, ARIZONA	2006	RECEIVED
	AUG 29	AZ STATE OFFICE
	A 10:20	
BLM DATE STAMP		

- 11. AMC \_\_\_\_\_
- 12. AMC \_\_\_\_\_
- 13. AMC \_\_\_\_\_
- 14. AMC \_\_\_\_\_
- 15. AMC \_\_\_\_\_
- 16. AMC \_\_\_\_\_
- 17. AMC \_\_\_\_\_
- 18. AMC \_\_\_\_\_
- 19. AMC \_\_\_\_\_
- 20. AMC \_\_\_\_\_

43 CFR 3833.0-5(e) (August 30, 1994) requires that the names of all of the owners and their current addresses shall be identified on all instruments required to be recorded or filed by the regulation, 43 CFR Subpart 3833.

NAME: \_\_\_\_\_ ADDRESS: \_\_\_\_\_  
 CITY: \_\_\_\_\_ STATE: \_\_\_\_\_ ZIP: \_\_\_\_\_ IS THIS A NEW ADDRESS ••

NAME: \_\_\_\_\_ ADDRESS: \_\_\_\_\_  
 CITY: \_\_\_\_\_ STATE: \_\_\_\_\_ ZIP: \_\_\_\_\_ IS THIS A NEW ADDRESS ••

NAME: \_\_\_\_\_ ADDRESS: \_\_\_\_\_  
 CITY: \_\_\_\_\_ STATE: \_\_\_\_\_ ZIP: \_\_\_\_\_ IS THIS A NEW ADDRESS ••

NAME: \_\_\_\_\_ ADDRESS: \_\_\_\_\_  
 CITY: \_\_\_\_\_ STATE: \_\_\_\_\_ ZIP: \_\_\_\_\_ IS THIS A NEW ADDRESS ••

January 30, 2003

<p>FOR BLM USE ONLY</p> <p>DATE ENTERED INTO COMPUTER: _____</p> <p>INITIALS: _____ VERIFIED: _____</p>
---

**United States Department of the Interior**  
**Bureau of Land Management**  
 BUSINESS & SUPPORT SVCS DIV  
 ONE N CENTRAL AVE  
 PHOENIX, AZ 85004 -2203  
 Phone: (602) 417-9200

Receipt

No:

1347655

<b>Transaction #:</b> 1392939	
<b>Date of Transaction:</b> 08/30/2006	
<b>CUSTOMER:</b>	WALTER SONNENBERG N 12315 WHEELER LN ATHELSTANE, WI 54104
<b>ENTERED INTO COMPUTER</b> SEP 01 2006 <i>PB m/fee</i>	

LINE #	QTY	DESCRIPTION	REMARKS	UNIT PRICE	TOTAL
1	1.00	LOCATABLE MINERALS / MINING CLAIMS-NOT NEW-UNADJUD, ONE AUTH NO. ONLY / MINING CLAIM MONEY RECEIVED (455) CASES: AMC358856/\$435.00	MAINT 2007 ✓ (3), POL 2006 (3)	- n/a -	435.00
<b>TOTAL:</b>					<b>\$435.00</b>

PAYMENT INFORMATION			
1	AMOUNT:	\$435.00	POSTMARKED: N/A
	TYPE:	CHECK	RECEIVED: 08/29/2006
	CHECK NO:	7859	
	NAME:	SONNENBERG, WALTER J N 12315 WHEELER LN ATHELSTANE WI 54104	

REMARKS

This receipt was generated by the automated BLM Collections and Billing System and is a paper representation of a portion of the official electronic record contained therein.



**United States Department of the Interior**  
**Bureau of Land Management**  
 BUSINESS & SUPPORT SVCS DIV  
 222 N CENTRAL AVE  
 PHOENIX, AZ 85004 -2203  
 Phone: (602) 417-9200

Receipt

No: 1140044

<b>Transaction #:</b> 1179273	
<b>Date of Transaction:</b> 08/29/2005	
<b>CUSTOMER:</b>	WALTER SONNENBERG N 12315 WHEELER LN ATHELSTANE, WI 54104

Amc 358854

LINE #	QTY	DESCRIPTION	REMARKS	UNIT PRICE	TOTAL
1	1.00	LOCATABLE MINERALS / MINING CLAIMS- NOT NEW-UNADJUD, ONE AUTH NO. ONLY / MINING CLAIM MONEY RECEIVED (455) <b>CASES: AMC358854/\$30.00</b>	POL 2005 (6)	- n/a -	30.00
<b>TOTAL:</b>					<b>\$30.00</b>

PAYMENT INFORMATION			
1	<b>AMOUNT:</b>	\$30.00	<b>POSTMARKED:</b> 08/25/2005
	<b>TYPE:</b>	CHECK	<b>RECEIVED:</b> 08/26/2005
	<b>CHECK NO:</b>	7737	
	<b>NAME:</b>	SONNENBERG, WALTER J N 12315 WHEELER LN ATHELSTANE WI 54104	

REMARKS

This receipt was generated by the automated BLM Collections and Billing System and is a paper representation of a portion of the official electronic record contained therein.

**MAINTENANCE FEE WAIVER CERTIFICATION**

**SEE INSTRUCTIONS ON REVERSE**

1. This small miner waiver is filed for the assessment year beginning at noon on September 1, 2005 and ending at noon on September 1, 2006
2. The undersigned and all related parties owned ten or fewer mining claims, mill, or tunnel sites located and maintained on Federal lands in the United States of America on September 1, 2005
3. The undersigned have performed the assessment work required by law for each mining claim listed prior to filing this waiver and understand that by filing this form; an affidavit of assessment work must be recorded by the December 30th following the filing of this waiver.
4. The undersigned understand that if the assessment work obligation has not yet come due under 30 U.S.C. 28 (for those claims in their first assessment year only); a notice of intent to hold reciting this condition must be recorded by the December 30th following the filing of this waiver.
5. The undersigned understand that mill and tunnel sites may also be listed upon this waiver and be waived from payment of the maintenance fee; and that a notice of intent to hold for these sites is required to be recorded by the December 30th immediately following the filing of this waiver.
6. The undersigned understand and acknowledge that pursuant to 43 U.S.C. 1212 and 18 U.S.C. 1001; the filing or recording of a false, fictitious, or fraudulent document with the Bureau of Land Management may result in a fine of up to \$250,000, a prison term not to exceed five years, or both.
7. The mining claims, mill or tunnel sites for which this waiver from payment of the maintenance fees is requested are:

CLAIM OR SITE NAME	BLM RECORDATION SERIAL NUMBER
1. MISSOURIE # 3 358856	031039401
2. missourie # 4 358857	031039402
3. MISSOURIE # 6 358859	031039404
4.	
5.	
6.	
7.	
8.	
9.	
10.	

The owner(s) (claimants) of the above mining claims and sites are:

WALTER Sonnenberg  
(Owner's Name - Please Print)  
N12315 Wheeler LN  
(Street or P.O. Box)  
ATHELSTANE WI 54104  
(City) (State) (Zip Code)

Walter Sonnenberg  
(Owner's Signature)  
715 856 5798  
520 241 1514

\_\_\_\_\_  
(Owner's Name - Please Print)  
\_\_\_\_\_  
(Street or P.O. Box)  
\_\_\_\_\_  
(City) (State) (Zip Code)

\_\_\_\_\_  
(Owner's Signature)

\_\_\_\_\_  
(Owner's Name - Please Print)  
\_\_\_\_\_  
(Street or P.O. Box)  
\_\_\_\_\_  
(City) (State) (Zip Code)

\_\_\_\_\_  
(Owner's Signature)

(Continued on page 2)

STN VS CIVIL OFFICE RECEIVED

ENTERED INTO COMPUTER

10/25/05 AB

(Owner's Name - Please Print)	(Owner's Signature)		
(Street or P.O. Box)	(City)	(State)	(Zip Code)
(Owner's Name - Please Print)	(Owner's Signature)		
(Street or P.O. Box)	(City)	(State)	(Zip Code)
(Owner's Name - Please Print)	(Owner's Signature)		
(Street or P.O. Box)	(City)	(State)	(Zip Code)
(Owner's Name - Please Print)	(Owner's Signature)		
(Street or P.O. Box)	(City)	(State)	(Zip Code)

**INSTRUCTIONS**

1. This certification is made under the provisions of § 1744 of Title 43 and § 28-28k of Title 30 of the United States Code; and the regulations thereunder (43 CFR Part 3830).
2. The claimant(s) must fill in the dates in paragraph 1 for the beginning and ending of the assessment year for which this waiver is sought.
3. The claimant(s) must fill in the date in paragraph 2 for the beginning of the assessment year for which this waiver is sought.
4. All claim and site names and Bureau of Land Management (BLM) serial numbers must be listed for the mining claims, mill sites, and tunnel sites for which the waiver is sought.
5. All owners of the mining claims, mill sites, and tunnel sites and their addresses must be given.
6. This waiver form must be signed by all the claimants or their designated agent, in original form. If an agent is designated, a notarized designation of agent, signed by all of the claimants with proper address given, must be submitted with this waiver.
7. This form must be filed no later than September 1st for the upcoming assessment year in the BLM State Office where the mining claims or sites are recorded, or the waiver cannot be granted by the BLM. (Example: to obtain a waiver for the assessment year 2000, which begins at noon on September 1, 1999, you must qualify for and file for a waiver no later than September 1, 1999, in the proper BLM State Office).
8. For all mining claims which require assessment work, you must record an affidavit of labor on or before the December 30th immediately following the filing of this waiver. For all other mining claims or sites waived, you must record a notice of intent to hold on or before the December 30th immediately following the filing of this waiver.
9. Mill and tunnel sites may also be listed upon this waiver and be waived from payment of the maintenance fee. A notice of intent to hold for these sites is required to be filed by the December 30th following the filing of this waiver.

**NOTICE/BURDEN HOURS STATEMENT**

The Privacy Act of 1974, *as amended*, and the regulation in 43 CFR 2.48(d) provide that you be furnished the following information in connection with the information required by this certification of waiver from rental fees.

**AUTHORITY:** 30 U.S.C. 28-28k; 43 U.S.C. 1201, 1457, 1740, and 1744; and 43 CFR 3830.

**PRINCIPLE PURPOSE:** This information is to be used to verify that the owner(s) (claimants) of a mining claim has complied with 30 U.S.C. 28f and is entitled to perform assessment work in lieu of paying the maintenance fee for the mining claims listed on this form.

**ROUTINE USE:** (1) Adjudication of the claimant(s) certification of waiver from paying the maintenance fee otherwise required by 30 U.S.C. 28f. (2) Disclosure may be made to appropriate Federal agencies when location is made within the agency's geographic area of responsibility. (3) Information from the record and/or the record will be transferred to the appropriate Federal, State, or local agency, or a member of the public in response to a specific request for pertinent information. (4) Information may also be provided to the Department of Justice or in a proceeding before a court or adjudicative body; or to Federal, State, local or foreign agencies when needed for enforcement of civil or criminal codes or applicable regulations concerning title rights upon the public land.

**EFFECT OF NOT PROVIDING INFORMATION:** Disclosure of this information is required by 30 U.S.C. 28f and 43 CFR Part 3830 for those qualified claimants wishing to take the small miner waiver allowed. Failure to supply the information required in this form to support the claimants certification of waiver from payment of the otherwise required maintenance fees will result in the waiver being disallowed and the mining claims subject to forfeiture by BLM under 30 U.S.C. 28i.

The Paperwork Reduction Act of 1995 requires us to inform you that:

This information is being collected to allow the BLM to determine if you qualify for a waiver from the payment of \$100 per mining claim or site maintenance fee established in 30 U.S.C. 28f and the implementing regulations at 43 CFR 3830. A response to this request is required in accordance with the statute to obtain your benefit.

BLM would like you to know that you do not have to respond to this, or any other, Federal agency-sponsored information collection unless it displays a currently valid OMB control number.

Public reporting burden for this form is estimated to average 8 minutes (0.133 hours) per response, including time to review instructions, gathering and maintaining data, and completing and reviewing the form. Direct comments regarding this burden estimate, or any other aspect of this form, to the U.S. Department of the Interior, Bureau of Land Management, (1004-0114) Bureau Information Collection Clearance Officer (WO-630), Mail Stop 401 LS, 1849 C St, N.W., Washington, D.C. 20240.

FOR OFFICIAL USE ONLY

PHOENIX, ARIZONA

2005 AUG 28 9 58

RECEIVED  
B.L.M. AZ STATE OFFICE

**MAINTENANCE FEE PAYMENT**

Mining Claim Maintenance Fee Payment of \$100 per claim or site is due on or before September 1, 2006 in lieu of assessment work for the upcoming assessment year beginning September 1 of the year noted above.

BUREAU OF LAND MANAGEMENT  
ARIZONA STATE OFFICE  
222 NORTH CENTRAL AVENUE  
PHOENIX, AZ 85004  
602-417-9200  
www.az.blm.gov

<b>FOR BLM USE ONLY</b>	
NO. OF CLAIMS: _____	X \$100 = \$ _____
RECEIPT NO: _____	CHECK NO: _____
INIT: _____	

BLM SERIAL NUMBERS	NAME OF CLAIMS/SITES	COUNTY BOOK/DOCKET & PAGE OR FEE NUMBER
1. AMC <u>358854</u>	<u>Missouri #1</u>	<u>031039399</u>
2. AMC <u>358855</u>	<u>11 #2</u>	<u>031039400</u>
3. AMC <u>358856</u>	<u>11 #3</u>	<u>031039401</u>
4. AMC <u>358857</u>	<u>11 #4</u>	<u>031039402</u>
5. AMC <u>358858</u>	<u>11 #5</u>	<u>031039403</u>
6. AMC <u>358859</u>	<u>11 #6</u>	<u>031039404</u>
7. AMC _____	_____	_____
8. AMC _____	_____	_____
9. AMC _____	_____	_____
10. AMC _____	_____	_____

List additional claims on the reverse side of this form.

**CHECK HERE IF THIS IS A CHANGE OF ADDRESS**

CLAIMANT'S NAME: WALTER Sonnenberg  
ADDRESS: 112315 Wheeler LN  
CITY: Athol STAN STATE: Wi ZIP: 54104  
PHONE: 715 956 5798

Signature: Walter Sonnenberg

To record with the County, one claimant or an agent must sign.

RECEIVED BUREAU OF LAND MANAGEMENT	2005 AUG 26 P 12:19	ARIZONA STATE OFFICE PHOENIX, ARIZONA
BLM DATE STAMP		



- 11. AMC \_\_\_\_\_
- 12. AMC \_\_\_\_\_
- 13. AMC \_\_\_\_\_
- 14. AMC \_\_\_\_\_
- 15. AMC \_\_\_\_\_
- 16. AMC \_\_\_\_\_
- 17. AMC \_\_\_\_\_
- 18. AMC \_\_\_\_\_
- 19. AMC \_\_\_\_\_
- 20. AMC \_\_\_\_\_

43 CFR 3833.0-5(e) (August 30, 1994) requires that the names of all of the owners and their current addresses shall be identified on all instruments required to be recorded or filed by the regulation, 43 CFR Subpart 3833.

NAME: \_\_\_\_\_ ADDRESS: \_\_\_\_\_  
 CITY: \_\_\_\_\_ STATE: \_\_\_\_\_ ZIP: \_\_\_\_\_ IS THIS A NEW ADDRESS ..

NAME: \_\_\_\_\_ ADDRESS: \_\_\_\_\_  
 CITY: \_\_\_\_\_ STATE: \_\_\_\_\_ ZIP: \_\_\_\_\_ IS THIS A NEW ADDRESS ..

NAME: \_\_\_\_\_ ADDRESS: \_\_\_\_\_  
 CITY: \_\_\_\_\_ STATE: \_\_\_\_\_ ZIP: \_\_\_\_\_ IS THIS A NEW ADDRESS ..

NAME: \_\_\_\_\_ ADDRESS: \_\_\_\_\_  
 CITY: \_\_\_\_\_ STATE: \_\_\_\_\_ ZIP: \_\_\_\_\_ IS THIS A NEW ADDRESS ..

January 30, 2003

<p>FOR BLM USE ONLY</p> <p>DATE ENTERED INTO COMPUTER: _____</p> <p>INITIALS: _____ VERIFIED: _____</p>
---

Return Document to:

A3850-1(NOV.2001)

WALTER Sonnenberg  
N12315 Wheeler LN  
ATHELSTANE Wi 54104  
Telephone: 715 856 5798

No. of Claims: \_\_\_\_\_ x \$5 = \_\_\_\_\_  
Receipt No.: \_\_\_\_\_ Check No.: \_\_\_\_\_  
Init: \_\_\_\_\_

FOR BLM USE ONLY

**AFFIDAVIT OF PERFORMANCE OF ANNUAL WORK.** Also fill in Items 1 through 9 and the reverse side of this document.

**NOTICE OF INTENTION TO HOLD.** I intend to hold the claims(s)/site(s) listed on the reverse side of this document for the calendar year 2005. Also fill in Items 1 through 4 and Item 9.

Notices of Intention to Hold are for mill sites and tunnel sites or for mining claims when assessment work has not been done, regardless of whether the annual assessment has been suspended, deferred, or not yet accrued. The filing of a Notice of Intention to Hold shall not relieve the owner of complying with federal and state laws pertaining to the performance of annual assessment work. Notices of Intention to Hold for mill sites or tunnel sites need not be county recorded. For mining claims the form filed with the Bureau of Land Management (BLM) must be identical to the one that was or will be filed with the county.

Evidence of Annual Assessment Work or a Notice of Intention to Hold must be filed each calendar year following the calendar year in which the claim/site was located. **All claims listed on a single affidavit must be contiguous.**

1. State of Arizona, County of Cochise ss:

2. I, (Name) WALTER Sonnenberg

3. Reside at (Address) N12315 Wheeler LN

City ATHELSTANE, County MARINETTE, State Wi Zip 54104

being duly sworn, deposes and says that he/she is a citizen of the United States, more than eighteen years of age, that all of the facts set forth in this affidavit/notice, subject to the provisions and penalties of 18 U.S.C. 1001 pertaining to the filing of false, fictitious, or fraudulent statements with the United States, are true and correct according to the best of my knowledge, information and belief.

4. Owner's name and address (If not shown in Items 1-3 above). **Check here if this is a change of address.**

5. That I am personally acquainted with the mining claim(s). The work and improvements were made by and at the expense of the owner(s) of said claim(s). Said contiguous group of claims, listed on the reverse side of this document, are situated in the \_\_\_\_\_ Mining District, Cochise County, Arizona.

6. That between the dates starting at 12 o'clock noon on September 1, 2004 and ending at 12 o'clock noon on September 1, 2005 at least \$ 76,900 dollars worth of work and improvements were done and performed upon said claim(s) or upon one or more of a contiguous group of claims for the benefit of all, or wholly or partly outside of a contiguous group of claims for the benefit of all, not including the location work.

7. That the following persons were employed to perform the work and improvements described herein:  
WALTER Sonnenberg

**ENTERED INTO COMPUTER**

10/19/05 QMB

8. That the work and improvements performed were: ATTEMPT TO DEWATER +  
CLAIM STAKE MISSING TWICE, REPLACED  
1 WATER PUMP 189.00 HOSES 600 GAS 120.00

9. Dated: 8-19-2005 Signature: Walter Sommerberg  
 SUBSCRIBED AND SWORN TO before me, a Notary Public, this 19 day of August, 2005  
 by Shirley A Staszewski  
 Notary Public Marquette County, WI  
 MY COMMISSION EXPIRES May 3, 2009

If the claims/sites have consecutive BLM numbers and are in the same Township, Range and Section(s), they may be listed as follows:

Claim/Site Name	Serial Number	Dkt/Pg or Record # of Orig Location Notice	TWN SHP	RNG	SEC(S)
<u>MISSOURI # 1</u>	<u>358854</u>	<u>031039399</u>	<u>18-5</u>	<u>23E</u>	<u>12</u>
<u>MISSOURI # 2</u>	<u>358855</u>	<u>031039400</u>			
<u>MISSOURI # 3</u>	<u>358856</u>	<u>031039401</u>			
<u>MISSOURI # 4</u>	<u>358857</u>	<u>031039402</u>			
<u>MISSOURI # 5</u>	<u>358858</u>	<u>031039403</u>			
<u>MISSOURI # 6</u>	<u>358859</u>	<u>031039404</u>			

BLM requires a \$5 nonrefundable service charge for each mining claim, mill site or tunnel site payable on or before December 30<sup>th</sup> (not the 31<sup>st</sup>). Mail to:

Bureau of Land Management  
 222 North Central Avenue  
 Phoenix, Arizona 85004-2203  
 602-417-9200  
 www.az.blm.gov

This form is for the purpose of complying with the laws of the United States Department of the Interior, Bureau of Land Management and the State of Arizona pertaining to assessment work and/or notice of intention to hold. 30 U.S.C. 28, 43 CFR 3833.2, ARS 27-208. Subject to Paperwork Reduction Act and Privacy Act statements available at the BLM AZ State Office. This form is not copyrighted. It may be reproduced without permission.

RECEIVED  
 BUREAU OF  
 LAND MANAGEMENT

2005 AUG 26 P 12:49

ARIZONA  
 STATE OFFICE  
 PHOENIX, ARIZONA

BLM Date Stamp

UNITED STATES  
DEPARTMENT OF THE INTERIOR  
BUREAU OF LAND MANAGEMENT

**MAINTENANCE FEE WAIVER CERTIFICATION**

SEE INSTRUCTIONS ON NEXT PAGE

54

FORM APPROVED  
OMB NO. 1004-0114  
Expires: November 30, 2003

AMC 358854

TES

1. This small miner waiver is filed for the assessment year beginning at noon on September 1, 2004 and ending at noon on September 1, 2005.
2. The undersigned and all related parties owned ten or fewer mining claims, mill, or tunnel sites located and maintained on Federal lands in the United States of America on September 1, 2004.
3. The undersigned have performed the assessment work required by law for each mining claim listed prior to filing this waiver and understand that by filing this form; an affidavit of assessment work must be recorded by the December 30th following the filing of this waiver.
4. The undersigned understand that if the assessment work obligation has not yet come due under 30 U.S.C. 28 (for those claims in their first assessment year only); a notice of intent to hold reciting this condition must be recorded by the December 30th following the filing of this waiver.
5. The undersigned understand that mill and tunnel sites may also be listed upon this waiver and be waived from payment of the maintenance fee; and that a notice of intent to hold for these sites is required to be recorded by the December 30th immediately following the filing of this waiver.
6. The undersigned understand and acknowledge that pursuant to 43 U.S.C. 1212 and 18 U.S.C. 1001; the filing or recording of a false, fictitious, or fraudulent document with the Bureau of Land Management may result in a fine of up to \$250,000, a prison term not to exceed five years, or both.
7. The mining claims, mill or tunnel sites for which this waiver from payment of the maintenance fees is requested are:

CLAIM OR SITE NAME	BLM RECORDATION SERIAL NUMBER
1. MISSOURI # 1	358854
2. MISSOURI # 2	358855
3. MISSOURI # 3	358856
4. MISSOURI # 4	358857
5. MISSOURI # 5	358858
6. MISSOURI # 6	358859
7.	
8.	
9.	
10.	

The owner(s) (claimant(s)) of the above mining claims and sites are:

Walter Samenberg  
 (Owner's Name - Please Print)  
 N 12315 Wheeler LN  
 (Street or P.O. Box)  
 Athelstone WI 54104  
 (City) (State) (Zip Code)

Walter Samenberg  
 (Owner's Signature)

(Owner's Name - Please Print)  
 (Street or P.O. Box)  
 (City) (State) (Zip Code)

(Owner's Signature)

(Owner's Name - Please Print)  
 (Street or P.O. Box)  
 (City) (State) (Zip Code)

(Owner's Signature)

ENTERED IN COMPUTER

7/21/04 MTH

(Owner's Name - Please Print)

(Owner's Signature)

(Street or P.O. Box)

(City)

(State)

(Zip Code)

(Owner's Name - Please Print)

(Owner's Signature)

(Street or P.O. Box)

(City)

(State)

(Zip Code)

(Owner's Name - Please Print)

(Owner's Signature)

(Street or P.O. Box)

(City)

(State)

(Zip Code)

(Owner's Name - Please Print)

(Owner's Signature)

(Street or P.O. Box)

(City)

(State)

(Zip Code)

**INSTRUCTIONS**

1. This certification is made under the provisions of § 1744 of Title 43 and § 28-28k of Title 30 of the United States Code; and the regulations thereunder (43 CFR Part 3830).
2. The claimant(s) **must** fill in the dates in paragraph 1 for the beginning and ending of the assessment year for which this waiver is sought.
3. The claimant(s) **must** fill in the date in paragraph 2 for the beginning of the assessment year for which this waiver is sought.
4. All claim and site names and Bureau of Land Management (BLM) serial numbers **must** be listed for the mining claims, mill sites, and tunnel sites for which the waiver is sought.
5. All owners of the mining claims, mill sites, and tunnel sites and their addresses **must** be given.
6. This waiver form **must** be signed by all the claimants or their designated agent, in original form. If an agent is designated, a notarized designation of agent, signed by all of the claimants with proper address given, **must** be submitted with this waiver.

7. This form **must** be filed no later than September 1st for the upcoming assessment year in the BLM State Office where the mining claims or sites are recorded, or the waiver cannot be granted by the BLM. (Example: to obtain a waiver for the assessment year 2000, which begins at noon on September 1, 1999, you **must** qualify for and file for a waiver no later than September 1, 1999 in the proper BLM State Office).
8. For all mining claims which require assessment work, you **must** record an affidavit of labor on or before the December 30th immediately following the filing of this waiver. For all other mining claims or sites waived, you **must** record a notice of intent to hold on or before the December 30th immediately following the filing of this waiver.
9. Mill and tunnel sites may also be listed upon this waiver and be waived from payment of the maintenance fee. A notice of intent to hold for these sites is required to be filed by the December 30th following the filing of this waiver.

**NOTICE/BURDEN HOURS STATEMENT**

The Privacy Act of 1974 and the regulations in 43 CFR 2.48(d) provide that you be furnished the following information in connection with the information required by this certification of waiver from rental fees.

**AUTHORITY:** 30 U.S.C. 28-28k; 43 U.S.C. 1201, 1457, 1740, and 1744; and 43 CFR 3830.

**PRINCIPLE PURPOSE:** This information is to be used to verify that the owner(s) (claimants) of a mining claim has complied with 30 U.S.C. 28f and is entitled to perform assessment work in lieu of paying the maintenance fee for the mining claims listed on this form.

**ROUTINE USE:** (1) Adjudication of the claimant(s) certification of waiver from paying the maintenance fee otherwise required by 30 U.S.C. 28f. (2) Disclosure may be made to appropriate Federal agencies when location is made within the agency's geographic area of responsibility. (3) Information from the record and/or the record will be transferred to the appropriate Federal, State, or local agency, or a member of the public in response to a specific request for pertinent information. (4) Information may also be provided to the Department of Justice or in a proceeding before a court or adjudicative body; or to Federal, State, local or foreign agencies when needed for enforcement of civil or criminal codes or applicable regulations concerning title rights upon the public land.

**EFFECT OF NOT PROVIDING INFORMATION:** Disclosure of this information is required by 30 U.S.C. 28f and 43 CFR Part 3830 for those qualified claimants wishing to take the small miner waiver allowed. Failure to supply the information required in this form to support the claimants certification of waiver from payment of the otherwise required maintenance fees will result in the waiver being disallowed and the mining claims subject to forfeiture by BLM under 30 U.S.C. 28i.

The Paperwork Reduction Act of 1995 requires us to inform you that:

This information is being collected to allow the BLM to determine if you qualify for a waiver from the payment of \$100 per mining claim or site maintenance fee established in 30 U.S.C. 28f and the implementing regulations at 43 CFR 3830. A response to this request is required in accordance with the statute to obtain your benefit.

BLM would like you to know that you do not have to respond to this, or any other, Federal agency-sponsored information collection unless it displays a currently valid OMB control number.

Public reporting burden for this form is estimated to average 8 minutes (0.133 hours) per response, including time to review instructions, gathering and maintaining data, and completing and reviewing the form. Direct comments regarding this burden estimate, or any other aspect of this form, to the U.S. Department of the Interior, Bureau of Land Management (1004-0114), Bureau Information Collection Clearance Officer (WO-630), Mail Stop 401 LS, 1849 C St., N.W., Washington, D.C. 20240.

**FOR OFFICIAL USE ONLY**

83 JUN 23 10 28

RECEIVED

Return Document to:

A3850-1 (NOV. 2001)

WALTER Sonnenberg  
N12315 Wheeler LN  
ATHELSTANE W: 54104  
Telephone: 715-856-5798

No. of Claims: <u>6</u>	x \$5 = <u>30.00</u>
Receipt No.: _____	Check No.: _____
Init: <u>TES</u>	
FOR BLM USE ONLY	

**AFFIDAVIT OF PERFORMANCE OF ANNUAL WORK.** Also fill in Items 1 through 9 and the reverse side of this document.

**NOTICE OF INTENTION TO HOLD.** I intend to hold the claims(s)/site(s) listed on the reverse side of this document for the calendar year 2004. Also fill in Items 1 through 4 and Item 9.

By Sopi

Notices of Intention to Hold are for mill sites and tunnel sites or for mining claims when assessment work has not been done, regardless of whether the annual assessment has been suspended, deferred, or not yet accrued. The filing of a Notice of Intention to Hold shall not relieve the owner of complying with federal and state laws pertaining to the performance of annual assessment work. Notices of Intention to Hold for mill sites or tunnel sites need not be county recorded. For mining claims the form filed with the Bureau of Land Management (BLM) must be identical to the one that was or will be filed with the county.

Evidence of Annual Assessment Work or a Notice of Intention to Hold must be filed each calendar year following the calendar year in which the claim/site was located. **All claims listed on a single affidavit must be contiguous.**

1. State of Arizona, County of Cochise ss:
2. I, (Name) WALTER Sonnenberg
3. Reside at (Address) N. 12315 Wheeler LN  
City ATHELSTANE, County MARINETTE State CO Zip 54104

being duly sworn, deposes and says that he/she is a citizen of the United States, more than eighteen years of age, that all of the facts set forth in this affidavit/notice, subject to the provisions and penalties of 18 U.S.C. 1001 pertaining to the filing of false, fictitious, or fraudulent statements with the United States, are true and correct according to the best of my knowledge, information and belief.

4. Owner's name and address (If not shown in Items 1-3 above). **Check here if this is a change of address.**

5. That I am personally acquainted with the mining claim(s). The work and improvements were made by and at the expense of the owner(s) of said claim(s). Said contiguous group of claims, listed on the reverse side of this document, are situated in the \_\_\_\_\_ Mining District, \_\_\_\_\_ County, Arizona.

6. That between the dates starting at 12 o'clock noon on September 1, 20\_\_\_\_ and ending at 12 o'clock noon on September 1, 20\_\_\_\_ at least \$ \_\_\_\_\_ Dollars worth of work and improvements were done and performed upon said claim(s) or upon one or more of a contiguous group of claims for the benefit of all, or wholly or partly outside of a contiguous group of claims for the benefit of all, not including the location work.

7. That the following persons were employed to perform the work and improvements described herein: \_\_\_\_\_

ENTERED IN COMPUTER  
7/21/04 MCH

8. That the work and improvements performed were: \_\_\_\_\_

9. Dated: 6-22-04 Signature: Walter J Sonnenberg

SUBSCRIBED AND SWORN TO before me, a Notary Public, this 22<sup>nd</sup> day of June, 2004  
by Walter J Sonnenberg  
Notary Public Mountain View, Arizona  
MY COMMISSION EXPIRES July 1, 2006



If the claims/sites have consecutive BLM numbers and are in the same Township, Range and Section(s), they may be listed as follows:

Sample 1 - 10	A MC 19640 - 49	Dkt/Pg 1025/1-10 Recording #9106173-82	4N 20W 36
Claim/Site Name	Serial Number	Dkt/Pg or Record # of Orig Location Notice	TWN SHP RNG SEC(S)
<u>MISSOURI #1</u>	<u>358854</u>	<u>031039399</u>	<u>18-S 23E 12</u>
<u>MISSOURI #2</u>	<u>358855</u>	<u>031039400</u>	<u>18-S 23E 12</u>
<u>MISSOURI #3</u>	<u>358856</u>	<u>031039401</u>	<u>18-S 23E 12</u>
<u>MISSOURI #4</u>	<u>358857</u>	<u>031039402</u>	<u>18-S 23E 12</u>
<u>MISSOURI #5</u>	<u>358858</u>	<u>031039403</u>	<u>18-S 23E 12</u>
<u>MISSOURI #6</u>	<u>358859</u>	<u>031039404</u>	<u>18-S 23E 12</u>
_____	_____	_____	_____
_____	_____	_____	_____
_____	_____	_____	_____
_____	_____	_____	_____

BLM requires a \$5 nonrefundable service charge for each mining claim, mill site or tunnel site payable on or before December 30<sup>th</sup> (not the 31<sup>st</sup>). Mail to:

Bureau of Land Management  
222 North Central Avenue  
Phoenix, Arizona 85004-2203  
602-417-9200  
www.az.blm.gov

This form is for the purpose of complying with the laws of the United States Department of the Interior, Bureau of Land Management and the State of Arizona pertaining to assessment work and/or notice of intention to hold. 30 U.S.C. 28, 43 CFR 3833.2, ARS 27-208. Subject to Paperwork Reduction Act and Privacy Act statements available at the BLM AZ State Office. This form is not copyrighted. It may be reproduced without permission.

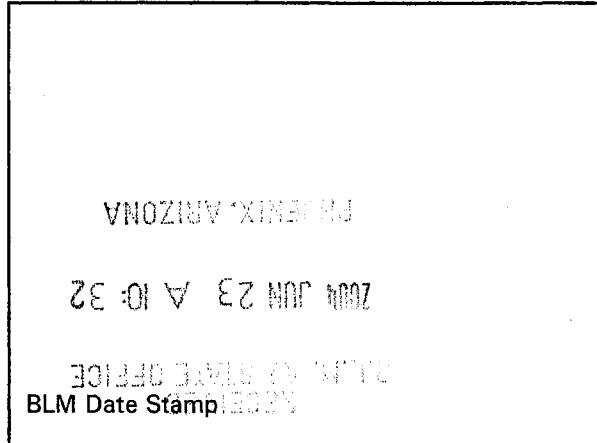

**United States Department of the Interior**  
**Bureau of Land Management**  
 BUSINESS & SUPPORT SVCS DIV  
 222 N CENTRAL AVE  
 PHOENIX, AZ 85004 -2203  
 Phone: (602) 417-9200

Receipt	
No:	897530

<b>Transaction #:</b> 931051	
<b>Date of Transaction:</b> 06/23/2004	
<b>CUSTOMER:</b>	WALTER SONNENBERG N 12315 WHEELER LN ATHELSTANE, WI 54104

LINE #	QTY	DESCRIPTION	REMARKS	UNIT PRICE	TOTAL
1	1.00	LOCATABLE MINERALS / MINING CLAIMS-NOT NEW-UNADJUD, ONE AUTH NO. ONLY / MINING CLAIM MONEY RECEIVED (455) <b>CASES:</b> AMC358854/\$30.00	NOI 2004 (6)	- n/a -	30.00
<b>TOTAL:</b>					<b>\$30.00</b>

PAYMENT INFORMATION			
1	<b>AMOUNT:</b>	\$30.00	<b>POSTMARKED:</b> N/A
	<b>TYPE:</b>	CASH	<b>RECEIVED:</b> 06/23/2004
	<b>NAME:</b>	SONNENBERG, WALTER N 12315 WHEELER LN ATHELSTANE WI 54104	

REMARKS

This receipt was generated by the automated BLM Collections and Billing System and is a paper representation of a portion of the official electronic record contained therein.



**NOTICE!!**

**These documents have been scanned!**

**Do not place un-scanned documents beneath this notice!**

**Do not remove this notice from this file!**

GPO Jacket No. 560-102  
Print Order 61540  
Rise Business Services, LLC  
Job=AZ15 6/6/2019



Box Number= AZ15121



Claim Begin-End: AMC358854-AMC358859

**5 Miscellaneous**



AZ15121-5

AMC358544-AMC359395

**NO  
DOCUMENTS  
FOUND**

NO DOCUMENTS FOUND  
NO DOCUMENTS FOUND

**NOTICE!!**

**These documents have been scanned!**

**Do not place un-scanned documents beneath this notice!**

**Do not remove this notice from this file!**

GPO Jacket No. 560-102  
Print Order 61540  
Rise Business Services, LLC  
Job=AZ15 6/6/2019



Box Number= AZ15121



Claim Begin-End: AMC358854-AMC358859

**6 Location Notices-Amendments and Supporting Documents**



AZ15121-5

AMC358544-AMC359395

**DEPARTMENT OF THE INTERIOR  
BUREAU OF LAND MANAGEMENT  
MINING CLAIMS  
(LIVE) Serial Register Page**

RunDate/Time: 03/20/06 08:31 AM

Page 1 of 3

**01 05-10-1872;017STAT0091;30USC26,28,34**  
**Case Type 384101: LODE CLAIM**  
**Claim Name: MISSOURI #1**  
**Commodity :**  
**Case Disposition: ACTIVE**

**Serial Number  
AMC358854**

Name & Address	Int Rel	% Interest
SONNENBERG WALTER J N 12315 WHEELER LN ATHELSTANE, WI 54104	CLAIMANT	0.0000000

Mer Twp	Rng	Sec	Quadrant	District/Resource	County
14	0180S	0230E	012 NE SE	TUCSON FIELD OFFICE	COCHISE

Act Date	Code	Action	Action Remarks	Receipt Number
10/28/2003	403	LOCATION DATE		792509
12/03/2003	395	RECORDATION NOTICE RECD	\$25.00;1	792509
08/26/2005	480	EVID OF ASSMT FILED	2005	1140044
06/23/2004	483	SMALL MINER CERT FILED	2005	
06/23/2004	480	EVID OF ASSMT FILED	2004	897530
12/03/2003	484	LOCATION YEAR / MAINTENANCE FEE	2004	792509
05/19/2005	669	LAND STATUS CHECKED		
12/03/2003	501	ACCT ADV IN LEAD FILE	AMC358854;	
10/31/2003	404	COUNTY RECORDATION	031039399	

Line Nr Remarks

*SEE yellow note re  
Main Fee Payment*

**MINING CLAIM STATUS REPORT**

Status Checked By:	<u>RP</u>
MTP Checked By:	<u>RP</u>
GEO Checked By:	<u>RP</u>
Preadjudication By:	
Final Adjudication By:	<u>5/19/05 RP</u>

LEAD SERIAL NO. AMC 358854 <sup>1001899</sup> THROUGH AMC 358859

<u>6</u>	LODE	@ \$25 = \$	<u>150</u>	Location Fee
	PLACER	@ \$10 = \$	<u>60</u>	Service Fee--curable defect
	MILL SITE	@ \$100 = \$	<u>600</u>	Claim Maintenance Fee
	TUNNEL SITE	\$		TOTAL FEES
	ASSOCIATION	\$		Copy Fees
	PLACER	\$		Overage <input type="checkbox"/> Shortage <input type="checkbox"/>
		\$	<u>810.00</u>	TOTAL RECEIVED

OVER-THE-COUNTER:  MAIL:  Timely Filed: YES  NO

**LEGAL DESCRIPTION:**

T <u>18s</u>	R <u>23E</u>	S <u>12</u>	T _____	R _____	S _____
T _____	R _____	S _____	T _____	R _____	S _____
T _____	R _____	S _____	T _____	R _____	S _____
T _____	R _____	S _____	T _____	R _____	S _____

GENERAL JURISDICTION: BLM  or NATIONAL FOREST  CORONADO  
Name

SPLIT ESTATE LAND SX  PX  SRHE  OTHER  NA  
Specify

WILDERNESS AREA (WA): NO  
Specify

CLAIMS SUBJECT TO PL 359: YES  NO

PROPER NOTICE FILED IF LOCATING ON SRHE: YES  NO  NA

COMMENTS: Forest Land Surface & Mineral

STATUS: PARTIALLY VOID  VOID   
PRIVATE MINERALS  WITHDRAWN  OTHER

COMMENTS: \_\_\_\_\_  
\_\_\_\_\_  
\_\_\_\_\_  
\_\_\_\_\_  
\_\_\_\_\_  
\_\_\_\_\_  
\_\_\_\_\_  
\_\_\_\_\_



FEE # 031039399  
 OFFICIAL RECORDS  
 COCHISE COUNTY  
 DATE 10/31/03 HOUR 12

REQUEST OF  
 SONNENBERG, WALTER  
 CHRISTINE RHODES-RECORDER  
 FEE : 10.00 PAGES : 2

**LOCATION NOTICE FOR LODE MINING CLAIM**

NOTICE IS HEREBY GIVEN that the Missouri # 1 lode mining claim has been

located by WALTER SONNENBERG, whose current mailing address is

N 12315 Wheeler LN Athelstane WI 54104.

The general course of this claim is S-W x N-E and it is situated in Cochise County, Arizona.

This claim is 1500' feet in length and 600' feet in width. This claim runs from the location monument on which this location notice is posted approximately 1490' feet in a N-E direction to the N-E end line and 10 feet in a S-W direction to the S-W end line. This claim is marked by six monuments, one at each corner and one at the center of each end line of the claim.

The location monument on which this notice is posted is situated within Section 12, Township 18 S, Range 23 E, Gila Salt River Base and Meridian, Arizona and this claim encompasses portions of the following quarter section (s), section (s), Township (s) and Range (s) Gila Salt River Base and Meridian, Arizona.

The locality of this claim with reference to some natural object or permanent monument and additional information (if any) concerning its locality are as follows: CLAIM IS ON

MIDDLE MARCH PASS Rd - MIDDLE MARCH CANYON

DATED AND POSTED on the ground this 28 day of OCT 2003

LOCATOR (s)

Walter Sonnenberg

031039399

RECEIVED  
 CLERK OF STATE OFFICE  
 PHOENIX ARIZONA  
 2003 DEC -3 A 10:00

AMC 358854

CLAIM MAP

Lode  Placer ( )

AMC 358854

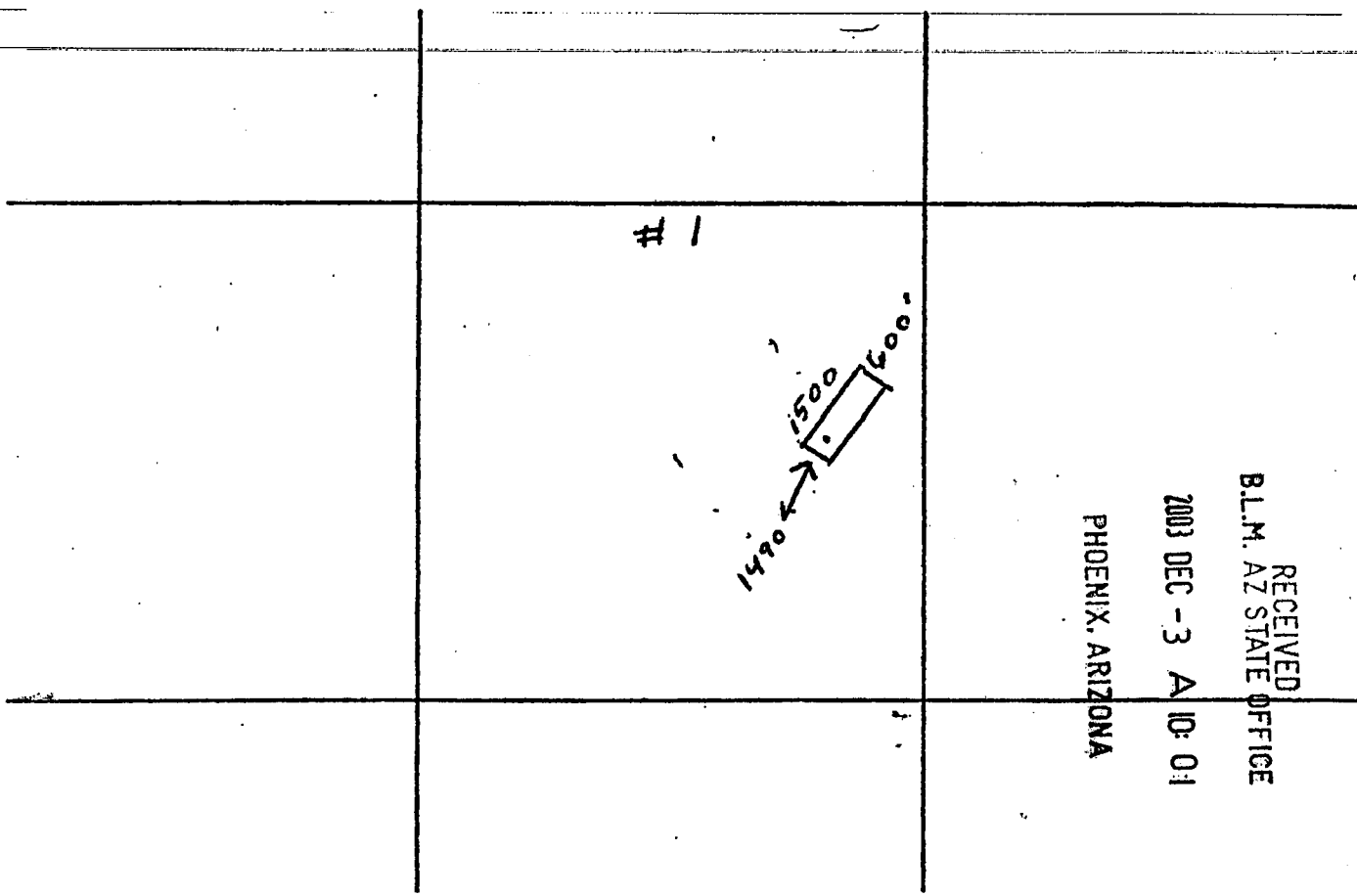

Scale: 1" = 3000'

1. The above map depicts the Missouri #1 mining claim, which is located in Section (s) 12, Township 18 S, Range 23 E, Gila and Salt River Base and Meridian, \_\_\_\_\_ County, Arizona.

2. The type of corner and location monuments used are as follows: 2" x 2" x 5' post

3. The bearings and distances in degrees and feet between claim corners are as depicted on the map.

031039399



FEE # 031039400  
 OFFICIAL RECORDS  
 COCHISE COUNTY  
 DATE 10/31/03 HOUR 12

REQUEST OF  
 SONNENBERG, WALTER  
 CHRISTINE RHODES-RECORDER  
 FEE : 10.00 PAGES : 2

**LOCATION NOTICE FOR LODE MINING CLAIM**

NOTICE IS HEREBY GIVEN that the Missouri # 2 lode mining claim has been located by WALTER SONNENBERG, whose current mailing address is

N12315 Wheeler LN Athelstone WI 54104

The general course of this claim is S-W x N-E and it is situated in Cochise County, Arizona.

This claim is 1500' feet in length and 600' feet in width. This claim runs ~~from~~ the location monument on which this location notice is posted approximately 1490 feet in a S-W direction to the S-W end line and 10' feet in a N-E direction to the N-E end line. This claim is marked by six monuments, one at each corner and one at the center of each end line of the claim.

The location monument on which this notice is posted is situated within Section 12, Township 18 S, Range 23 E, Gila Salt River Base and Meridian, Arizona and this claim encompasses portions of the following quarter section (s), section (s), Township (s) and Range (s):  
Gila Salt River Base and Meridian, Arizona.

The locality of this claim with reference to some natural object or permanent monument additional information (if any) concerning its locality are as follows: CLAM 1  
Middle March PASS Rd - Middle March PLANON

DATED AND POSTED on the ground this 28 day of OCT 2003

LOCATOR (s)  
Walter Sonnenberg

031039400

PHOENIX, ARIZONA  
 DEC - 3 AM 3:30  
 RECEIVED  
 M. AZ STATE OFFICE

AMC 358855



CLAIM MAP

Lode (X) Placer ( )

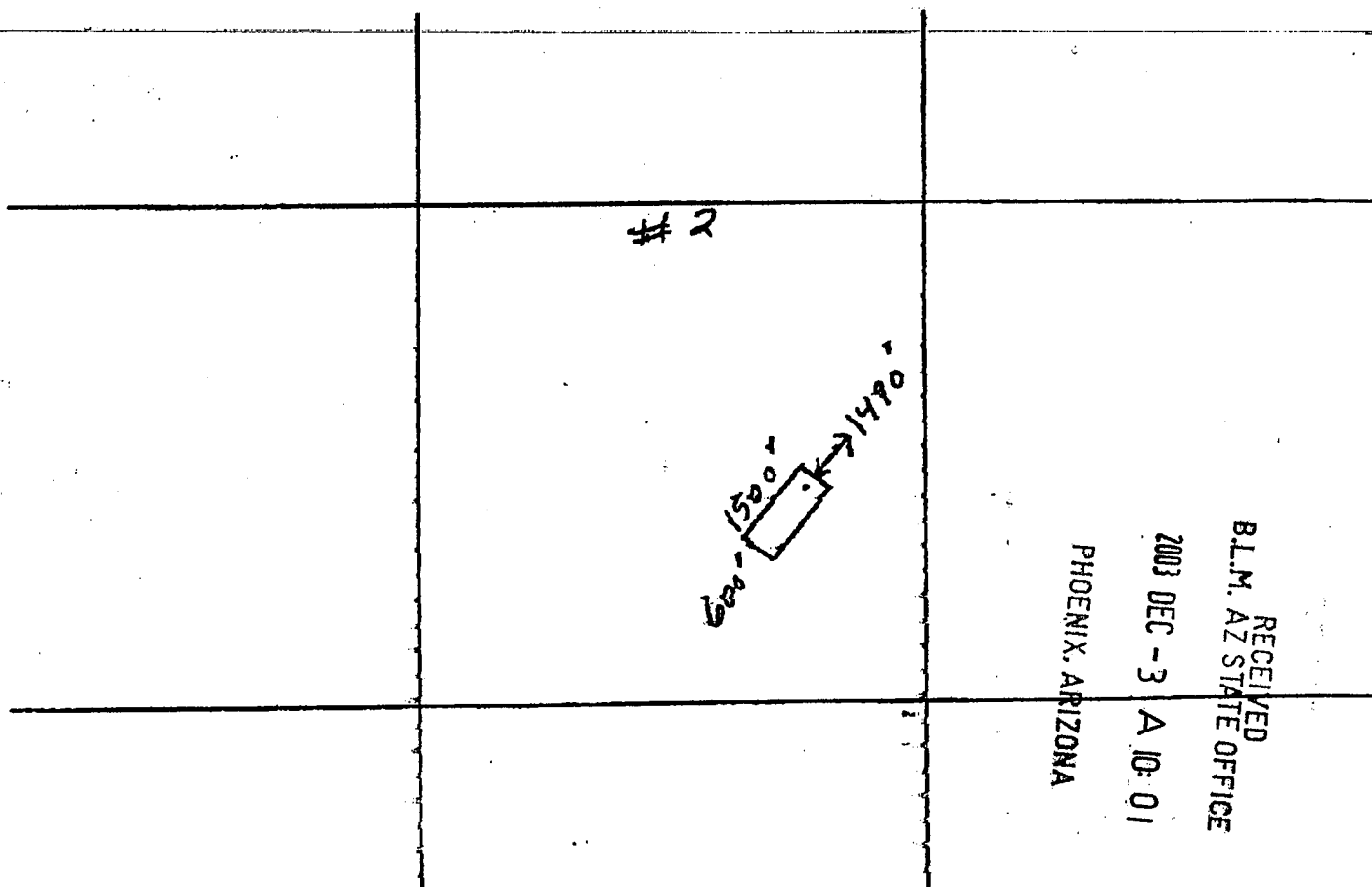

RECEIVED  
 B.L.M. AZ STATE OFFICE  
 2003 DEC - 3 A 10: 01  
 PHOENIX, ARIZONA

AMC 358855

Scale: 1" = 3000'

1. The above map depicts the MISSOURI #2 mining claim, which is located in Section (s) 12, Township 18 S, Range 23 E, Gila and Salt River Base and Meridian, Cochise County, Arizona.

2. The type of corner and location monuments used are as follows: 2" x 2" x 5' POST

3. The bearings and distances in degrees and feet between claim corners are as depicted on the map.

03:039400



FEE # 031039401  
 OFFICIAL RECORDS  
 COCHISE COUNTY  
 DATE 10/31/03 HOUR 12

REQUEST OF  
 SONNENBERG, WALTER  
 CHRISTINE RHODES-RECORDER  
 FEE : 10.00 PAGES : 2

**LOCATION NOTICE FOR LODE MINING CLAIM**

NOTICE IS HEREBY GIVEN that the MISSOURI #3 lode mining claim has been located by WALTER SONNENBERG, whose current mailing address is N 12315 WHEELER LN ATHELSTANE WI 54104.

The general course of this claim is S-W X NE and it is situated in Cochise County, Arizona.

This claim is 1500 feet in length and 600 feet in width. This claim runs from the location monument on which this location notice is posted approximately 1490 feet in a N-E direction to the NE end line and 10 feet in a S-W direction to the S-W end line. This claim is marked by six monuments, one at each corner and one at the center of each end line of the claim.

The location monument on which this notice is posted is situated within Section 12, Township 18 S, Range 23 E, Gila Salt River Base and Meridian, Arizona and this claim encompasses portions of the following quarter section (s), section (s), Township (s) and Range (s)

Gila Salt River Base and Meridian, Arizona.

The locality of this claim with reference to some natural object or permanent monument and additional information (if any) concerning its locality are as follows: CLAIM

MIDDLE MARCH PASS RD - MIDDLE MARCH CANYON

DATED AND POSTED on the ground this 28 day of OCT 2003

LOCATOR (s)

Walter Sonnenberg

RECEIVED  
 L.M. AZ STATE OFFICE  
 2003 DEC - 3  
 PHOENIX, ARIZONA

AMT 358856

031039401

CLAIM MAP

Lode (X) Placer ( )

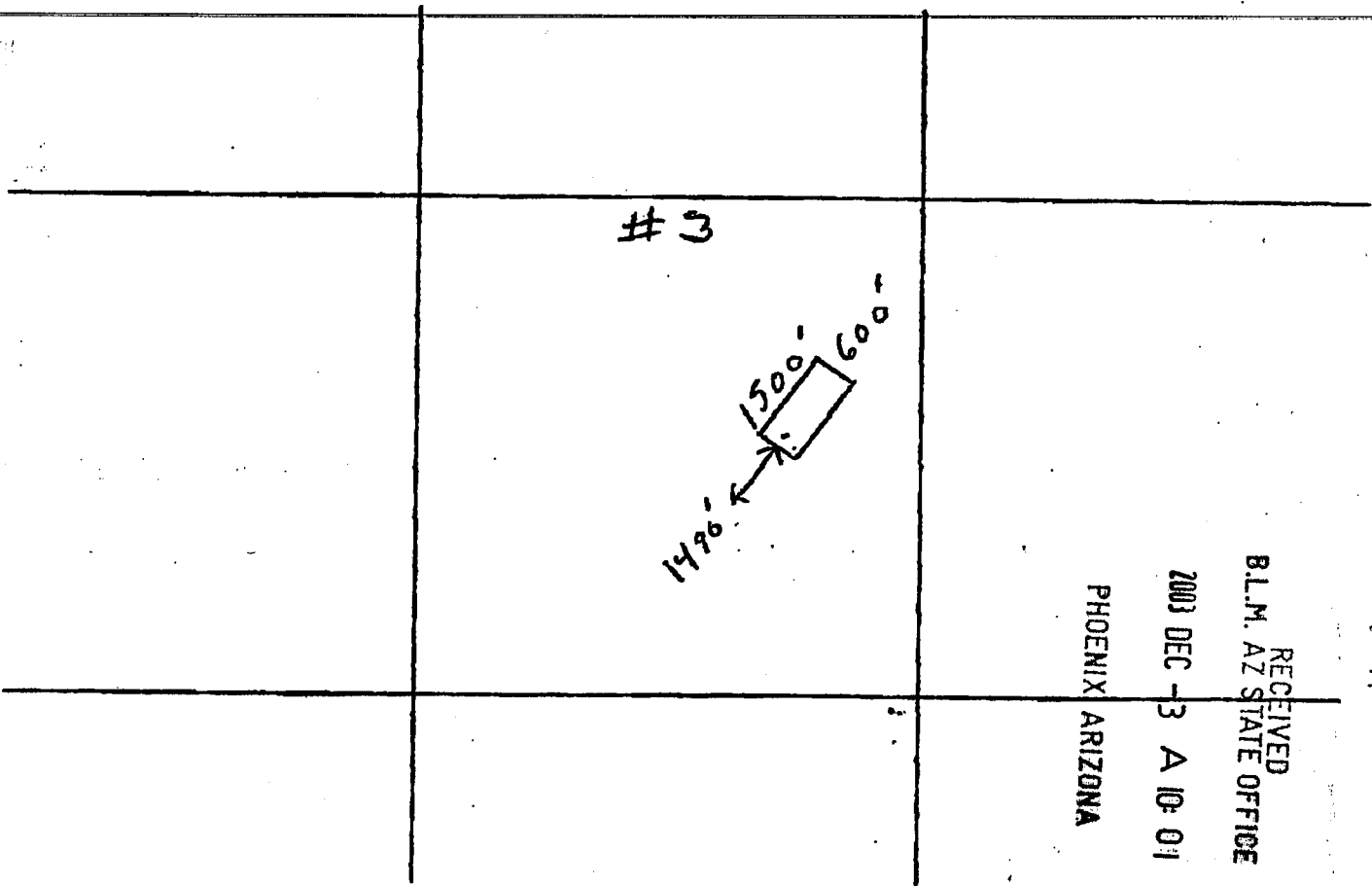

RECEIVED  
 B.L.M. AZ STATE OFFICE  
 2003 DEC -3 A 10:01  
 PHOENIX ARIZONA

AND 35885b  
 A

Scale: 1" = 3000'

1. The above map depicts the Missouri #3 mining claim, which is located in Section (s) 12, Township 18 S, Range 23 E, Gila and Salt River Base and Meridian, Cochise County, Arizona.
2. The type of corner and location monuments used are as follows: 2' x 2' x 5' post
3. The bearings and distances in degrees and feet between claim corners are as depicted on the map.



FEE # 031039402  
 OFFICIAL RECORDS  
 COCHISE COUNTY  
 DATE 10/31/03 HOUR 12

REQUEST OF  
 SONNENBERG, WALTER  
 CHRISTINE RHODES-RECORDER  
 FEE : 10.00 PAGES : 2

**LOCATION NOTICE FOR LODE MINING CLAIM**

NOTICE IS HEREBY GIVEN that the MISSOURI #4 lode mining claim has been located by WALTER SONNENBERG, whose current mailing address is N 12315 WHEELER LN ATHELSTAVE WI 54104.

The general course of this claim is S-W X NE and it is situated in Cochise County, Arizona.

This claim is 1500 feet in length and 600 feet in width. This claim runs from the location monument on which this location notice is posted approximately 1490 feet in a S-W direction to the S-W end line and 10 feet in a N-E direction to the N-E end line. This claim is marked by six monuments, one at each corner and one at the center of each end line of the claim.

The location monument on which this notice is posted is situated within Section 22 Township 18 S, Range 23 E, Gila Salt River Base and Meridian, Arizona and this claim encompasses portions of the following quarter section (s), section (s), Township (s) and Range (s)

Gila Salt River Base and Meridian, Arizona.

The locality of this claim with reference to some natural object or permanent monument and additional information (if any) concerning its locality are as follows: CLAIM IS ON MIDDLEMARCH PASS RD - MIDDLEMARCH CANYON

DATED AND POSTED on the ground this 28 day of OCT 2003

LOCATOR (s)

Walter Sonnenberg

031039402

RECEIVED  
 B.L.M. STATE OFFICE  
 PHOENIX, ARIZONA  
 2003 DEC -3 A 10 01

AMC 358857

CLAIM MAP

Lode ~~Co~~ Pacer ( )

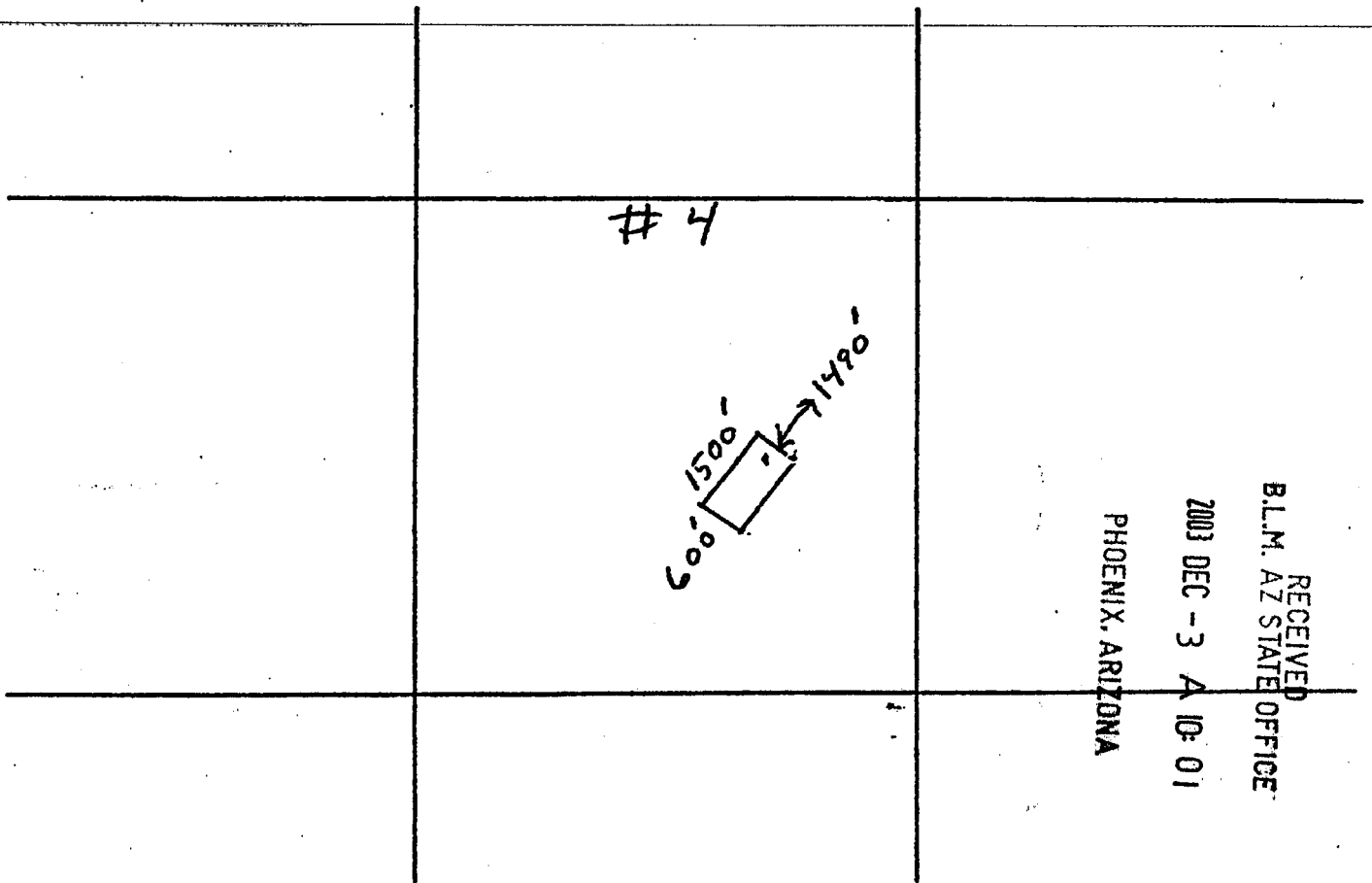

RECEIVED  
 B.L.M. AZ STATE OFFICE  
 2003 DEC - 3 A 10: 01  
 PHOENIX, ARIZONA

AMC 358857

Scale : 1" = 3000'

1. The above map depicts the MISSOURI # 4 mining claim, which is located in Section (s) 12, Township 18 S, Range 23 E, Gila and Salt River Base and Meridian, Cochise County, Arizona.

2. The type of corner and location monuments used are as follows: 2" x 2" x 5"

3. The bearings and distances in degrees and feet between claim corners are as depicted on the map.

031039402



FEE # 031039403  
 OFFICIAL RECORDS  
 COCHISE COUNTY  
 DATE 10/31/03 HOUR 12

REQUEST OF  
 SONNENBERG, WALTER  
 CHRISTINE RHODES-RECORDER  
 FEE : 10.00 PAGES : 2

**LOCATION NOTICE FOR LODE MINING CLAIM**

NOTICE IS HEREBY GIVEN that the Missouri # 5 lode mining claim has been located by WALTER SONNENBERG, whose current mailing address is N 12315 Wheeler LN ATHLETSTAVE WI 54104.

The general course of this claim is S-W X NE and it is situated in Cochise County, Arizona.

This claim is 1500 feet in length and 600 feet in width. This claim runs from the location monument on which this location notice is posted approximately 1490 feet in a N-E direction to the N-E end line and 10 feet in a S-W direction to the                      end line. This claim is marked by six monuments, one at each corner and one at the center of each end line of the claim.

The location monument on which this notice is posted is situated within Section 12, Township 18 S, Range 23 E, Gila Salt River Base and Meridian, Arizona and this claim encompasses portions of the following quarter section (s), section (s), Township (s) and Range (s)

Gila Salt River Base and Meridian, Arizona.

The locality of this claim with reference to some natural object or permanent monument and additional information (if any) concerning its locality are as follows: CLAIM IS ON MIDDLE MARCH PASS RD - MIDDLE MARCH CANYON

DATED AND POSTED on the ground this 28 day of OCT 2003

LOCATOR (s)  
Walter Sonnenberg

031039403

RECEIVED  
 B.L. AND STATE OFFICE  
 2003 DEC -3 A 10:0  
 PHOENIX, ARIZONA

AMC 358858

CLAIM MAP

~~1000' X 1000'~~

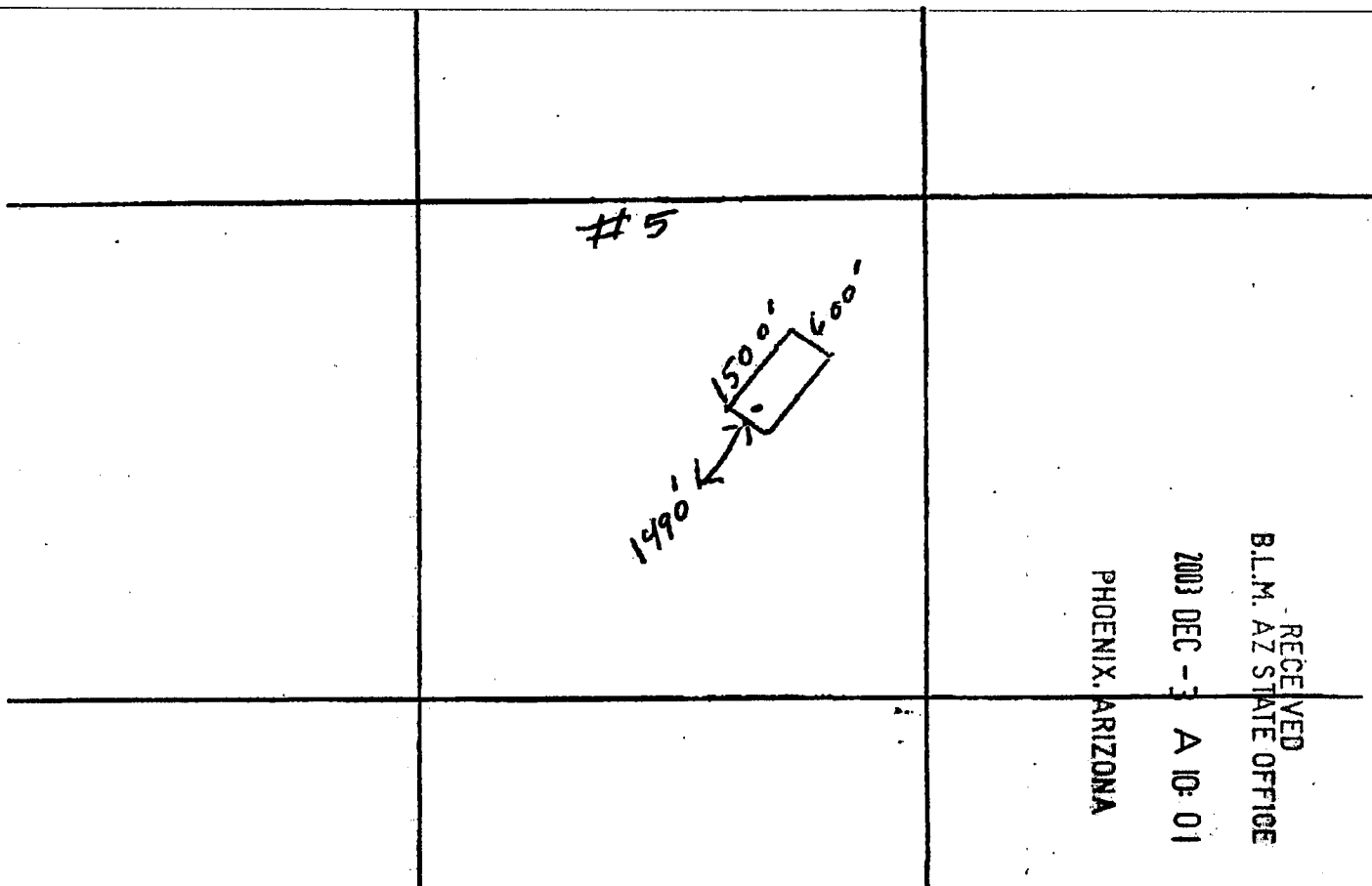

RECEIVED  
 B.L.M. AZ STATE OFFICE  
 2003 DEC - 3 A 10: 01  
 PHOENIX, ARIZONA

AMP 358858

Scale: 1" = 3000'

1. The above map depicts the MISSOURI #5 mining claim, which is located in Section (s) 12, Township 18 S, Range 23 E, Gila and Salt River Base and Meridian, Cochise County, Arizona.

2. The type of corner and location monuments used are as follows: 2" x 2" x 5'

3. The bearings and distances in degrees and feet between claim corners are as depicted on the map.

031039403



FEE # 031039404  
 OFFICIAL RECORDS  
 COCHISE COUNTY  
 DATE 10/31/03 HOUR 12

REQUEST OF  
 SONNENBERG, WALTER  
 CHRISTINE RHODES-RECORDER  
 FEE : 10.00 PAGES : 2

**LOCATION NOTICE FOR LODE MINING CLAIM**

NOTICE IS HEREBY GIVEN that the Missouri # 6 lode mining claim has been located by WALTER SONNENBERG, whose current mailing address is

N 12315 WHEELER LN ATHELSTANE WI 54104

The general course of this claim is S-W X NE and it is situated in

Cochise County, Arizona.

This claim is 1500 feet in length and 600 feet in width. This claim runs from the location monument on which this location notice is posted approximately 1490 feet in a S-W direction to the S-W end line and 10 feet in a NE direction to the N-E end line. This claim is marked by six monuments, one at each corner and one at the center of each end line of the claim.

The location monument on which this notice is posted is situated within Section 12, Township 18 S, Range 23 E, Gila Salt River Base and Meridian, Arizona and this claim encompasses portions of the following quarter section (s), section (s), Township (s) and Range (s)

Gila Salt River Base and Meridian, Arizona.

The locality of this claim with reference to some natural object or permanent monument and additional information (if any) concerning its locality are as follows: CLAIM IS ON

MIDDLE MARCH PASS RD - MIDDLE MARCH CANYON

DATED AND POSTED on the ground this 28 day of OCT 2003

LOCATOR (s)

Walter Sonnenberg

031039404

RECEIVED  
 B.M. STATE OFFICE  
 OCT - 3 10:01  
 HOHOKI, ARIZONA

AMC 358859



CLAIM MAP

Lode (X) - Placer ( )

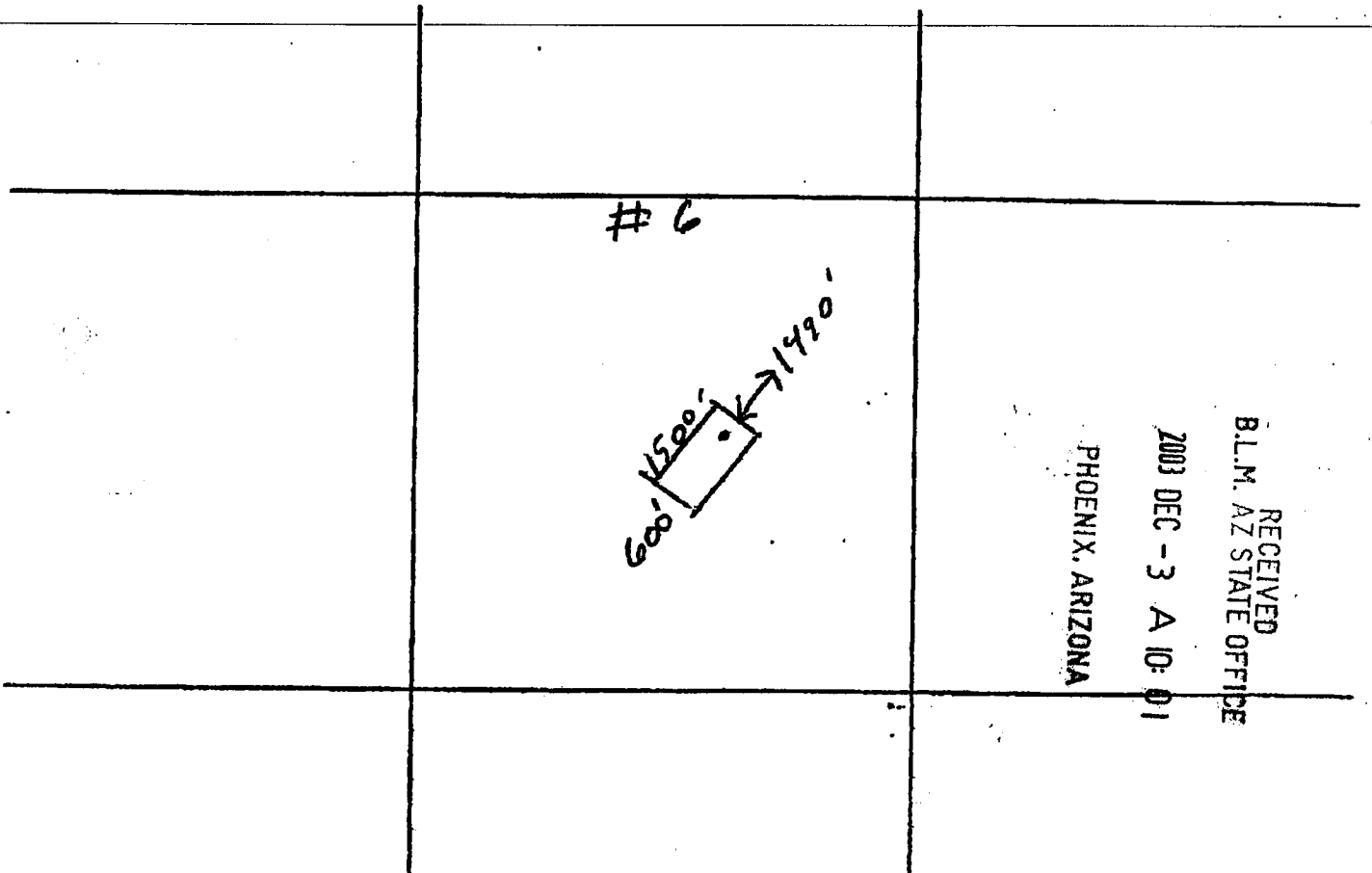

AMC 358859

Scale: 1" = 3000'

1. The above map depicts the MISSOURI # 6 mining claim, which is located in Section (s) 12, Township 18 S, Range 23 E, Gila and Salt River Base and Meridian, Cochise County, Arizona.

2. The type of corner and location monuments used are as follows: 2" x 2" x 5'

3. The bearings and distances in degrees and feet between claim corners are as depicted on the map.

031039404

Input Parameters for Geographic Report with Land

System Id = CR

Admin State = AZ

Geo State =

Casetype begins with

Case Disp Txt =

Mer Twp Rng =

Mtrs = 14 0180S 0230E 012

Commodity =

Pending Org =

Section =

Total Rows Returned: 1

RUN TIME: 10:01 AM

Adm State: AZ

UNITED STATES DEPARTMENT OF INTERIOR  
BUREAU OF LAND MANAGEMENT  
GEOGRAPHIC REPORT WITH LAND  
Sorted by Meridian Township Range

RUN DATE: 12/03/2003

Page 1 of 1

Serial Number: AZA 015825

Total Case Acres: 7,769.670

<u>Casetype</u>	<u>Case Disp</u>				<u>Sect</u>	<u>Sur Typ</u>	<u>Sur Num</u>	<u>Suff</u>	<u>Subdivision</u>	<u>Act Pend</u>
311111	CLOSED	14	0180S	0230E	012	ALIQ			ALL;	



